

The information contained in this drawing is the sole property of CWS Coil Winding Specialist. Any reproduction in part or whole without written permission of CWS Coil Winding Specialist is prohibited.

REVISION HISTORY		REV	ECN	DESCRIPTION	DATE	BY	CHK	DATE
B				PRODUCTION RELEASE	3/22/05	TLK	JLU	3/22/05

- 6 WHERE SHOWN, USING A PERMANENT EPOXY INK MARK PART NUMBER AND REVISION IN (BLACK) APPROX WRAP INDUCTOR WITH GLASS TAPE. (PER NOTE 2)
- 5 MUST REST FLAT ON PCB). LEADS MUST BE TANGENT TO THE CORE FLUSH WITH THE COIL EDGE, AS SHOWN (I.E. COIL REMOVE INSULATION AND TIN LEADS APPROX. 0.7 INCH
- 4 WIND COILS EVENLY SPACED
- 3 CONSTRUCTION:

INSULATION COVERING HAS NOT BEEN BREACHED
 HI-POT TEST COIL TO COIL, 250VDC TO INSURE INTEGRITY OF WINDING
 POWER LOSS 3.87W MAX @ 60A
 DCR = 1mOHMS MAX (ALL 3 STRANDS IN PARALLEL)
 L = 5uH MIN (10 KHZ), <1Vrms); > 4uH @ 60A DC BIAS
 3 SPECIFICATIONS:

OUTER WRAP: GLASS CLOTH TAPE
 WIRE: UL RECOGNIZED 200' C RATING MAGNET WIRE
 SUPPLIER: CWS BYTEMARK (www.cwsbytemark.com)
 2 CORE: MPP TORROID
 RATING CLASS B (130°) REQUIRED
 1. MATERIAL: UL RECOGNIZED 94V-2 FLAMMABILITY
 NOTES: READ FROM BOTTOM UP.

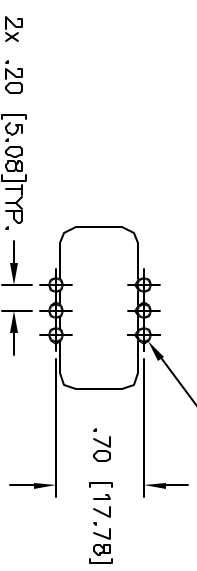
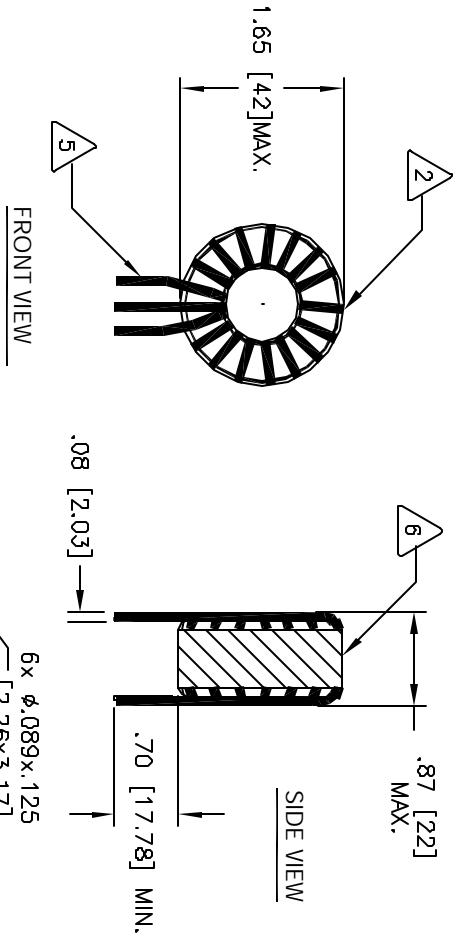

CODE IDENT	MFG. P/N	DESCRIPTION	ITEM NO.
AUTOCAD SOLIDWORKS SIGN	X		
DATE	DATE		
3/22/05	3/22/05		
TKK/JLU	TKK/JLU		
3/22/05	3/22/05		
JLU	JLU		
3/22/05	3/22/05		

SIZE	TMR. ID.	REV
B	10445-5U-60A	B

SCALE	SHEET	OF
1=1	1	1