

The information contained in this drawing is the sole property of CWS Coil Winding Specialist. Any reproduction in part or whole without written permission of CWS Coil Winding Specialist is prohibited.

REVISION HISTORY

REV	ECN	DESCRIPTION	SIGN & DATE			
			BY	DATE	CHK	DATE
A		PRODUCTION RELEASE	TDK	2/09/04	JLJU	2/9/04

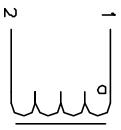

SCHEMATIC

USING A PERMANENT MARKING METHOD

MARK PART NUMBER AND REVISION, IF APPLICABLE  
IF NEEDED, WRAP INDUCTOR WITH GLASS TAPE

TO THE CORE

MUST REST FLAT ON PCB. LEADS MUST BE TANGENT  
FLUSH WITH THE COIL EDGE. AS SHOWN (I.E. COIL  
REMOVE INSULATION AND TIN LEADS 0.75 INCH

5 WIND COILS EVENLY SPACED AROUND THE CORE  
CONSTRUCTION:

HI-POT TEST FOR WINDING TO CORE ISOLATION = 500VDC MIN  
CURRENT RATING : 12.8 AMPS, 40 °C TEMP. RISE, NO AIR FLOW  
DCR = 7.0 MILLI-OHMS MAX.

3 DC BIASED = 12.8 AMPS, INDUCTANCE = 22 UH  
DC BIASED = 20 AMPS, INDUCTANCE = 20 UH  
INDUCTANCE = 25 UH +/-10% @ LOW DC BIAS, 1 KHZ, 250mV  
SPECIFICATIONS:

2 WIRE: UL RECOGNIZED 200°C RATED MAGNET WIRE  
CWS BYTEMARK OR OTHER APPROVED PART  
CORE: COATED HIGH FLUX TOROIDAL CORE

1 RATING CLASS B (130°C MIN.) REQUIRED  
MATERIAL: UL RECOGNIZED 94V-0 FOR FLAMMABILITY

NOTES: TOROIDAL POWER CHOKER. ALL DIMENSIONS IN INCHES

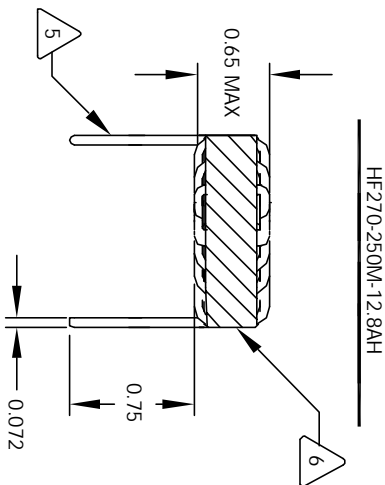

FRONT VIEW

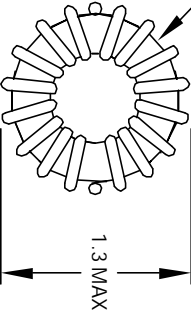

BOTTOM VIEW

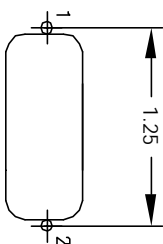

MOUNTING HOLES PATTERN

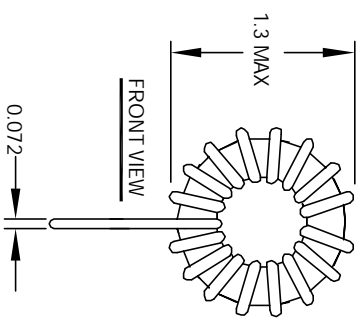

FRONT VIEW

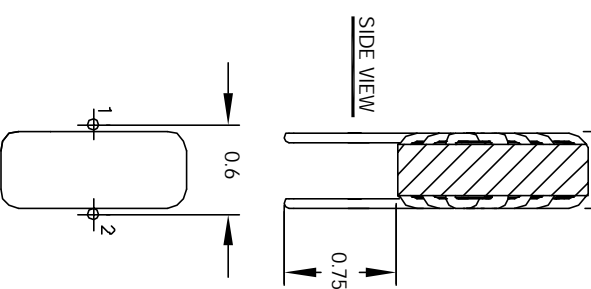

SIDE VIEW

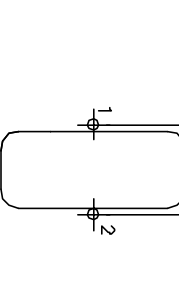

MOUNTING HOLES PATTERN

CODE	IDENT	MFG. P/N	DESCRIPTION	ITEM NO.
AUTOCAD		X		
SOLIDWORKS				
SIGN		DATE	PARTS LIST	
DRWN	TDK	2/8/04	CWS Coil Winding Specialist.	
DRWD	JLJU	2/9/04	1510 E. Edinger Ave	
ENGR.	KSUM	3/5/04	Unit B, Santa Ana, CA. 92705	
APPR.	JLJU	3/6/04	Toroidal Power Chokes	
SIZE			TITLE	
SCALE			Toroidal Power Chokes	
B			HF270-250M-12.8A	
2=1			REV B	