

The information contained in this drawing is the sole property of CWS Coil Winding Specialist. Any reproduction in part or whole without written permission of CWS Coil Winding Specialist is prohibited.

REVISION HISTORY			
REV	ECN	DESCRIPTION	DATE
A		PRODUCTION RELEASE	9/02/04

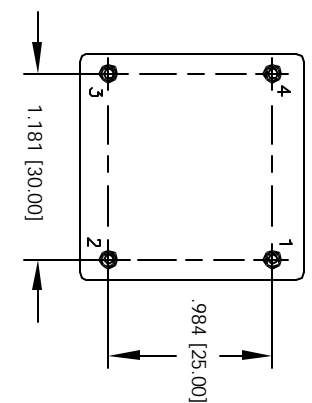
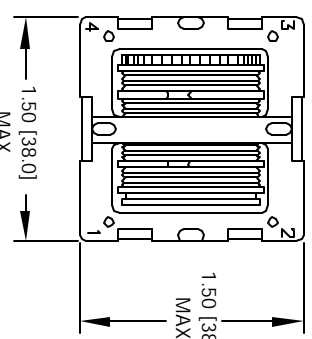
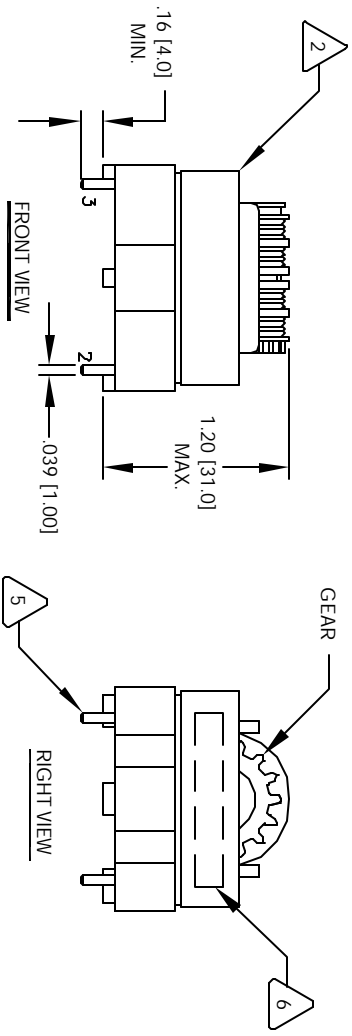
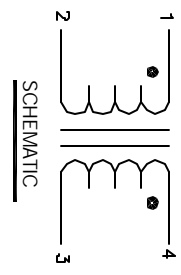

5 REMOVE INSULATION AND SOLDER TO BOBBIN LEADS

4 WIND BOTH COILS EVENLY SPACED ON BOBBIN CONSTRUCTION:

INSURE INTERGRITY OF WINDING SEPARATION
 HI-POT TEST FOR INTERWINDING ISOLATION, 1250VDC TO WIRE SIZE DIAMETER = 1.0 MILLIMETER
 NUMBER OF TURNS = 23
 DCR = 0.04 MILLI-OHMS MAX
 CURRENT RATING = 6A AC
 L = 2.20 mH MIN @ 10 KHZ, 0.250 Vrms:
 3 SPECIFICATIONS@ 25 °C

2 WIRE: UL RECOGNIZED 130° RATED MAGNET WIRE
 CWS BYTEMARK OR OTHER APPROVED PART
 CORE: SINGLE PIECE FERRITE H CORE

1 BOBBIN RATING CLASS B (130°) REQUIRED
 MATERIAL: UL RECOGNIZED 94V-0 FOR FLAMMABILITY
 NOTES: UNLESS OTHERWISE SPECIFIED.

QTY	UM	CODE IDENT	MFG. P/N	DESCRIPTION	ITEM NO.																														
		X		PARTS LIST																															
<table border="1"> <tr> <td>AUTOCAD SOLIDWORKS SIGN</td> <td>X</td> <td>DATE</td> <td colspan="3">CWS Coil Winding Specialist. www.cwswind.com</td> </tr> <tr> <td>UNLESS OTHERWISE SPECIFIED TOLERANCE PER ANSI Y14.5M ALL DIMENSIONS ARE IN INCHES AND [DIMENSIONS]</td> <td>DATE</td> <td colspan="4">1510 E. Edinger Ave Unit B, Santa Ana, CA 92705</td> </tr> <tr> <td>TOLERANCE INCHES: .0005±.010 .0005±.015 .0005±.0254 .0005±.03</td> <td>DATE</td> <td colspan="4">Common Mode Line Filter Horizontal Mount Chokes</td> </tr> <tr> <td>ANGLE PRECISION</td> <td>DATE</td> <td colspan="4">SIZE: DIM. IN. 35H_2K2</td> </tr> <tr> <td>DO NOT SCALE DRAWING</td> <td>DATE</td> <td colspan="4">SCALE: 1=1</td> </tr> </table>						AUTOCAD SOLIDWORKS SIGN	X	DATE	CWS Coil Winding Specialist. www.cwswind.com			UNLESS OTHERWISE SPECIFIED TOLERANCE PER ANSI Y14.5M ALL DIMENSIONS ARE IN INCHES AND [DIMENSIONS]	DATE	1510 E. Edinger Ave Unit B, Santa Ana, CA 92705				TOLERANCE INCHES: .0005±.010 .0005±.015 .0005±.0254 .0005±.03	DATE	Common Mode Line Filter Horizontal Mount Chokes				ANGLE PRECISION	DATE	SIZE: DIM. IN. 35H_2K2				DO NOT SCALE DRAWING	DATE	SCALE: 1=1			
AUTOCAD SOLIDWORKS SIGN	X	DATE	CWS Coil Winding Specialist. www.cwswind.com																																
UNLESS OTHERWISE SPECIFIED TOLERANCE PER ANSI Y14.5M ALL DIMENSIONS ARE IN INCHES AND [DIMENSIONS]	DATE	1510 E. Edinger Ave Unit B, Santa Ana, CA 92705																																	
TOLERANCE INCHES: .0005±.010 .0005±.015 .0005±.0254 .0005±.03	DATE	Common Mode Line Filter Horizontal Mount Chokes																																	
ANGLE PRECISION	DATE	SIZE: DIM. IN. 35H_2K2																																	
DO NOT SCALE DRAWING	DATE	SCALE: 1=1																																	
APPR: JLAU	DATE: 6/02/03	DATE: 6/02/03	DATE: 6/02/04	DATE: 6/02/03	DATE: 9/04/03																														
					REV A																														