

The information contained in this drawing is the sole property of Coil Winding Specialist, Inc. Any reproduction in part or whole without written permission of Coil Winding Specialist is prohibited.

REVISION HISTORY

REV	ECN	DESCRIPTION	BY	DATE	CHK	DATE
D		PRODUCTION RELEASE	BJN	6/06/07	JLJU	6/06/07
D1		UPDATED SPECIFICATIONS	GN	2/07/11	JLJU	2/07/11
D2		UPDATED SPECIFICATIONS	AK	6/18/12	JLJU	6/18/12
E		MECH. SPECS CHANGE	GN	8/13/12	AK	8/13/12

- 8 BUILT TO ROHS COMPLIANCE AND LEAD FREE.
- \*\*IMPORTANT\*\*  
TO ACHIEVE THE DESIRED INDUCTANCE AND DCR THE CORES MUST TOUCH EACH OTHER
- 7 WHERE SHOWN, USING A PERMANENT MARKING METHOD MARK PART NUMBER AND REVISION APPROX OVER CORES, (PER NOTE 2)
- 6 APPLY EPOXY ON MATINGS SURFACES AND WRAP TAPE
- 5 FLUSH TO THE COIL EDGE, AS SHOWN
- REMOVE INSULATION AND TIN LEADS
- 4 PRE FORMED FLAT HELICAL COIL, HELIX WOULD EVENLY SPACED CONSTRUCTION

- 3 UNFINISHED WITH DOLPH EPOXY: UNIBON OR CWS APPROVED PART OUTER WRAP: 3M GLASS CLOTH OR CWS APPROVED PART WIRE: UL RECOGNIZED 200°C RATED MAGNET WIRE CORE: SENDUST/KOOLMU POWDER CORE @ 300°C
- 2 INSULATION CLASS 200°C REQUIRED
- 1 MATERIAL: UL RECOGNIZED 94V-0 FOR FLAMMABILITY

NOTES: UNLESS OTHERWISE SPECIFIED, READ FROM BOTTOM UP.

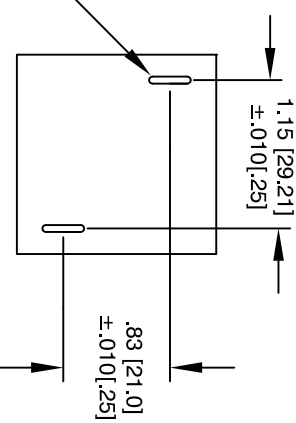
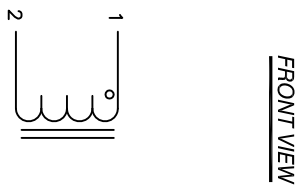
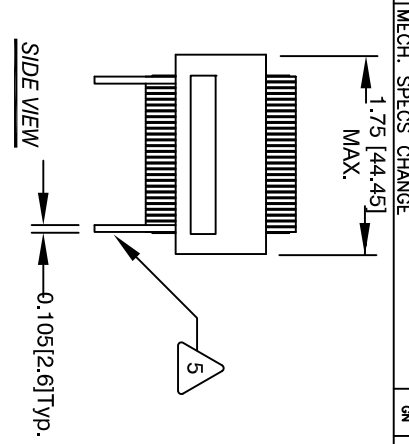
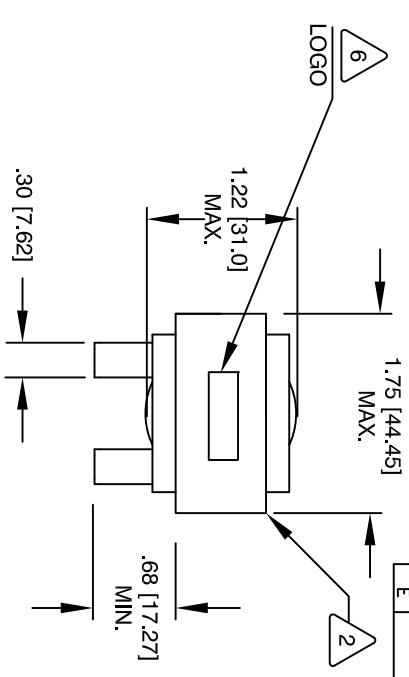

QTY	CODE IDENT	MFG. P/N	DESCRIPTION	ITEM NO.
			<b>PARTS LIST</b>	
	AUTOCAD			
	SOLIDWORKS			
	SIGN	DATE		
	DRWNN	6/06/07		
	BUN	6/06/07		
	CHKD	6/06/07		
	JLJU	6/06/07		
	ENGR	6/06/07		
	KSUM	6/06/07		
	APPR	6/06/07		
	JLJU	6/06/07		

UNLESS OTHERWISE SPECIFIED	
DIMENSIONING AND TOLERANCE PER ANS Y14.5M AND [MILLIMETERS].	
TOLERANCE INCHES:	±.0030
XXX±.010 XX±.020	±.0030
TOLERANCE METRICS:	±.030
XXX±.254 XX±.127	±.030
ANGLE PROJECTION	DO NOT SCALE DRAWING

TITLE:	Helical Output Inductors
SIZE	180 Amps
SCALE	E70340-010
NOT TO SCALE	
SHEET	1 OF 1
REV	E