

The information contained in this drawing is the sole property of Coil Winding Specialist, Inc. Any reproduction in part or whole without written permission of Coil Winding Specialist, Inc. is prohibited.

REVISION HISTORY

REV	ECN	DESCRIPTION	BY	DATE	CHK	DATE
A		PRODUCTION RELEASE	RL	3/21/11	JCL	3/21/11

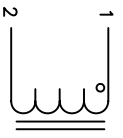

SCHEMATIC

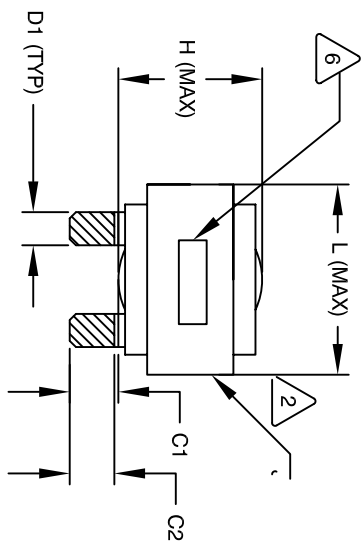

FRONT VIEW

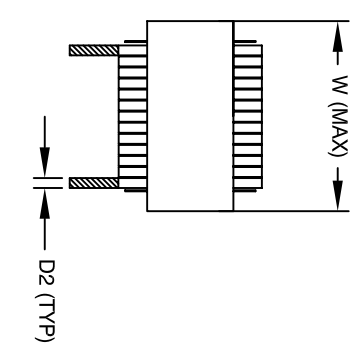

SIDE VIEW

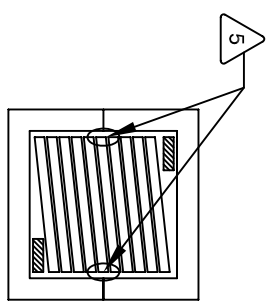

BOTTOM VIEW

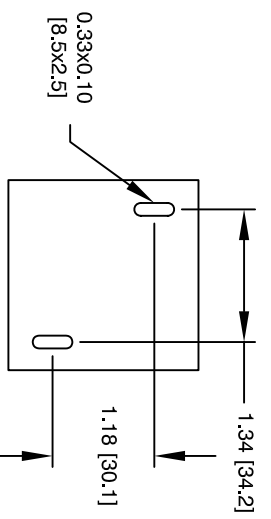

MOUNTING HOLES PATTERN

DIMENSIONAL TOLERANCE

	mm	inch
C1	14.23 ± 1.50	0.56 ± 0.06
C2	12.12 ± 1.00	0.48 ± 0.04
D1	7.50 (TYP)	0.30 (TYP)
D2	1.50 (TYP)	0.06 (TYP)
L	58.0 MAX	2.29 MAX
W	58.0 MAX	2.29 MAX
H	36.0 MAX	1.42 MAX

DC-BIAS	L
0A	86 uH
5A	83 uH
10A	78 uH
15A	72 uH
20A	65 uH
25A	59 uH
30A	56 uH
35A	53 uH
40A	49 uH
45A	45 uH
50A	41 uH
55A	38 uH

7 BUILT TO ROHS COMPLIANCE AND LEAD FREE.

6 MARK PART NUMBER AND REVISION WHERE SHOWN

5 VANISH PART AND CURE APPLY SILICON WHERE SHOWN

4 WRAP TAPE AROUND CORES WITH CORES AND NOMEX SPACERS ASSEMBLE PRE FORMED FLAT HELICAL COIL CONSTRUCTION

WEIGHT: 415 GRAM (TYP)
 RECOMMENDED OPERATING TEMP: -40°C TO 85°C AT 55 °C AMBIENT
 HI-POT TEST FOR WINDING TO CORE ISOLATION, 1000VDC @ 2mA, 1 MIN
 INTERWINDING CAPACITANCE @ 10KHZ = 19pF (TYP)
 |z|@SRF=5.5 KILO-OHM
 SRF=3.8 MHz
 RATED CURRENT: 75 AMPS
 DCR = 3.0 MILLI-OHM MAX., USING GW INSTEK GOM-801H OR EQUAL
 L@DC BIAS: SEE TABLE ON RIGHT.
 L = 80 uH ± 15%, MEASURED AT 10 KHZ, 0.25V, ZERO DC BIAS
 SPECIFICATIONS:

2 VANISH DOLPH or EQUAL SILICON DOW CORNING OR EQUAL NOMEX SPACERS FOR SIDE AND CENTER LEG OF CORES OUTER WRAP: 3M GLASS OR EQUAL WIRE: UL RECOGNIZED 200°C RATED MAGNET WIRE CORE: COMPACTED POWDERED CORE

1 INSULATION CLASS 200°C REQUIRED MATERIAL: UL RECOGNIZED 94V-0 FOR FLAMMABILITY

NOTES: UNLESS OTHERWISE SPECIFIED, READ FROM BOTTOM UP.

QTY	CODE IDENT	MFG. P/N	DESCRIPTION	ITEM NO.
			PARTS LIST	
			www.coilws.com	
			Coil Winding Specialist, Inc.	
			353 W. GROVE AVE	
			ORANGE, CA 92665	
			TITLE:	
			High Current Helical Inductor	
			80 uH, 75 Amps, Horizontal	
			SCALE:	
			NOT_TO_SCALE	
			SIZE Dwg. NO.:	
			ESS55206-800M-75AH	
			SCALE:	
			NOT_SCALE	
			SHEET 1 OF 1	