

SCHEMATIC

REVISION HISTORY		SIGN & DATE				
REV	ECN	DESCRIPTION	BY	DATE	CHK	DATE
A		PRODUCTION RELEASE	TN	04/06/18	JL	04/06/18
A1		ADDED P1 & P2 DIMENSIONS	TN	10/31/18	JL	10/31/18

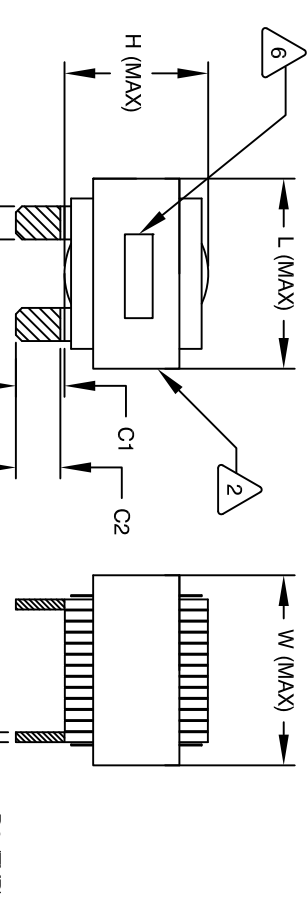

DIMENSIONAL TOLERANCE

	mm	inch
C1	17.63 (TYP)	0.69 (TYP)
C2	13.05 (TYP)	0.51 (TYP)
D1	7.05 (TYP)	0.28 (TYP)
D2	0.80 (TYP)	0.03 (TYP)
L	58.0 MAX	2.28 MAX
W	58.0 MAX	2.28 MAX
H	36.0 MAX	1.42 MAX
P1	34.45 ± 1.50	1.36 ± 0.06
P2	27.00 ± 1.50	1.06 ± 0.06

FRONT VIEW

SIDE VIEW

- 6 MARK PART NUMBER, REVISION AND DATE CODE WHERE SHOWN
- 5 VANISH PART AND CURVE APPLY SILICON WHERE SHOWN
- 4 WRAP TAPE AROUND CORES WITH CORES AND NOMEX SPACERS ASSEMBLE PRE FORMED FLAT HELICAL COIL CONSTRUCTION:

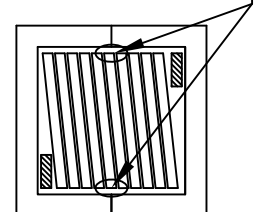

BOTTOM VIEW

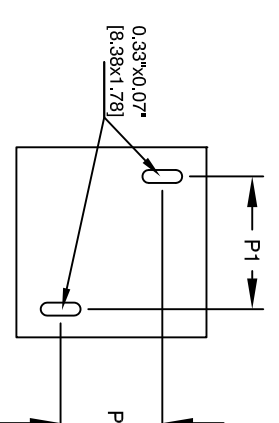

MOUNTING HOLES PATTERN

INDUCTOR DC BIAS TABLE

DC BIAS	INDUCTANCE (TYP)
0A	163 uH
5A	160 uH
10A	155 uH
15A	149 uH
20A	142 uH
25A	133 uH
30A	122 uH
35A	110 uH
40A	100 uH

- 3 VANISH DOLPH or EQUAL SILICON DOW CORNING OR EQUAL NOMEX SPACERS FOR SIDE AND CENTER LEG OF CORES OUTER WRAP: 3M GLASS OR EQUAL WIRE: UL RECOGNIZED 200°C RATED MAGNET WIRE CORE: COMPACTED POWDERED CORE
- 2 INSULATION CLASS 200°C REQUIRED MATERIAL: UL RECOGNIZED 94V-0 FOR FLAMMABILITY

NOTES: UNLESS OTHERWISE SPECIFIED, READ FROM BOTTOM UP.  
CAGE CODE: SDME2

QTY	CODE IDENT	MFG. P/N	DESCRIPTION	ITEM NO.
			<b>PARTS LIST</b>	
			www.coilws.com sales@coilws.com	
			Coil Winding Specialist, Inc. 353 W. GROVE AVE ORANGE, CA 92665	
			<b>TITLE:</b> High Current Helical Inductor 160 uH, 40 Amps, Horizontal	
			<b>SIZE:</b> DIM: NO. ESS55246-161M-40AH	
			<b>SCALE:</b> NOT_TO_SCALE	
			<b>SHEET:</b> 1 OF 1	