

B

FOR REFERENCE ONLY

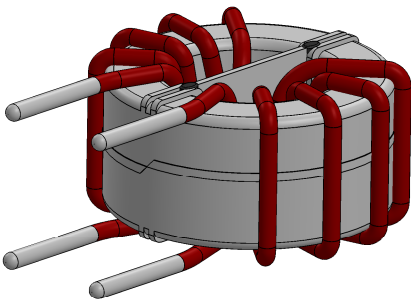
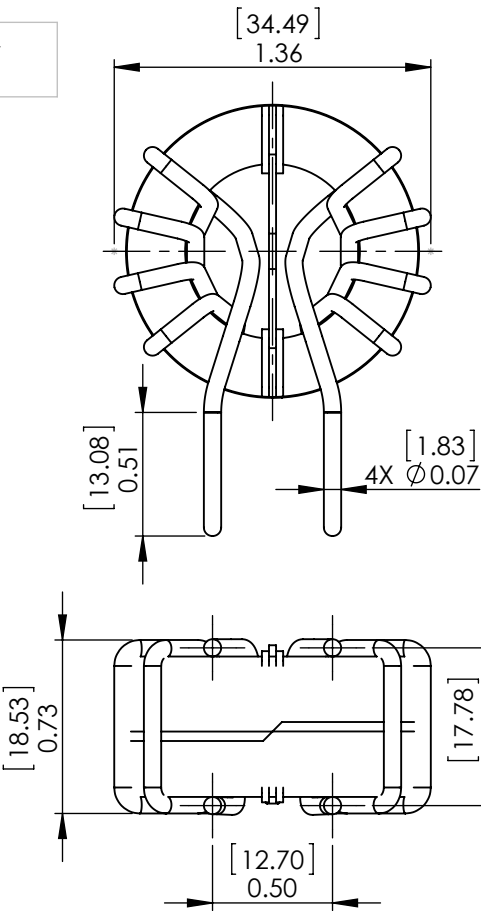

B

A

- THE PART NUMBER ON THE WEBSITE.
4. PLEASE REFER TO OFFICIAL AUTOCAD PDF DRAWING BY CLICKING
3. DIMENSIONS ARE FOR REFERENCE ONLY WITH NO TOLERANCES.

- THE SOLIDWORKS DRAWING.
2. DIMENSIONS SHOWN ARE FOR ONE TYPICAL UNIT USED IN
1. DRAWING DERIVED FROM SOLIDWORKS STEP FILE.

NOTES : UNLESS OTHERWISE SPECIFIED, READ FROM BOTTOM UP.

PROPRIETARY AND CONFIDENTIAL

THE INFORMATION CONTAINED IN THIS DRAWING IS THE SOLE PROPERTY OF COIL WINDING SPECIALIST, INC. ANY REPRODUCTION IN PART OR AS A WHOLE WITHOUT THE WRITTEN PERMISSION OF COIL WINDING SPECIALIST, INC. IS PROHIBITED.

UNLESS OTHERWISE SPECIFIED:				PDF DERIVED FROM SOLIDWORKS		
DIMENSIONS ARE IN INCHES TOLERANCES: FRACTIONAL ± ANGULAR: MACH ± BEND ± TWO PLACE DECIMAL ± THREE PLACE DECIMAL ± INTERPRET GEOMETRIC TOLERANCING PER: MATERIAL FINISH DO NOT SCALE DRAWING	DRAWN	JJ	07/31/20	TITLE: SolidWorks Version of Common Mode Chokes Vertical Mount SIZE DWG. NO. REV A HL-V-151U-20A-SW A SCALE: 1.25:1 WEIGHT: SHEET 1 OF 1		
	CHECKED	TN	07/31/20			
	ENG APPR.	JL	07/31/20			
	MFG APPR.	JL	07/31/20			
	Q.A.	JM	07/31/20			
COMMENTS:						

A