

The information contained in this drawing is the sole property of CMS Coil Winding Specialist. Any reproduction in part or whole without written permission of CMS Coil Winding Specialist is prohibited.

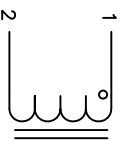

- 10 BUILT TO ROHS COMPLIANCE.
- 9 VARNISH (REMOVE FROM TOP, BOTTOM, AND INSIDE OF BOBBIN)
- 8 LEAD LENGTH 4", STRIP END 0.25", #18 GA. WHITE TEFLON
- 7 USE SINGLE ENAMEL MAGNET COIL WIRE
- 6 BREAK AND DEBURR EDGES
- 5 IF APPLICABLE, LABEL PART NUMBER AND REVISION
- POSITION LEADS AS REQUIRED
REMOVE WIRE INSULATION AND TIN
WIND COILS EVENLY SPACED
- 4 CONSTRUCTION:
FREQUENCY = 60HZ
VOLTAGE = 48 AC
DCR = 4Ω ±10% MAX
SRF = 245 KHZ
MAX TEMP. RISE @ IDC 1.5 AMP. LESS THAN 25°C WITH NO AIRFLOW
INDUCTANCE = 3.5mH TYP.
TEST FREQUENCY: 1.0 KHZ ; TEST VOLTAGE: 250mV
RATED MAX. CURRENT = 1.5 AMPS RMS
OPERATING TEMPERATURE RANGE : -40° TO 180°C
- 3 SPECIFICATIONS @ 25°C
WIRE: UL RATED CLASS 180°C
CORE: AIR
- 2 RATING: UL-CLASS H (180°C) REQUIRED
MATERIAL: UL RECOGNIZED FLAMMABILITY
- 1 NOTES: UNLESS OTHERWISE SPECIFIED. READ NOTES FROM BOTTOM TO UP.

DIMENSIONAL TOLERANCES INCHES [MM]						
A	B	C	D	E	F	G
MAX	MAX	MIN	MAX	REF	MAX	MAX
1.18 [30.00]	1.81 [46.00]	4.00 [101.60]	1.26 [32.00]	0.25 [6.35]	1.04 [26.50]	0.55 [14.00]

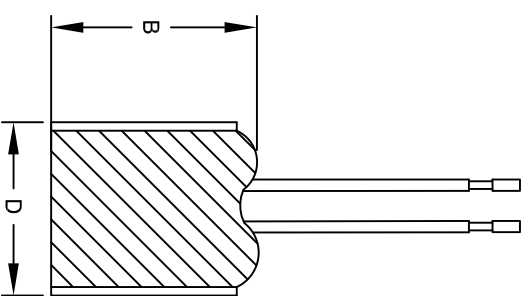
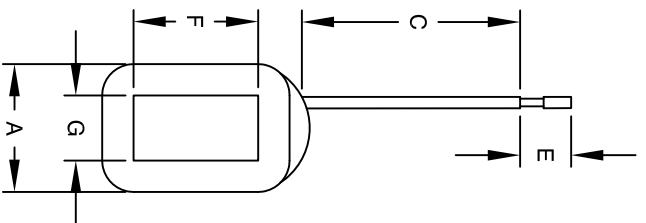

REVISION HISTORY						
REV	ECN	DESCRIPTION	SIGN & DATE			
			BY	DATE	CHK	DATE
A		PRODUCTION RELEASE	JL	09/08/17	JL	09/08/17

CODE IDENT	MFG. P/N	DESCRIPTION	ITEM NO.
PARTS LIST			
AUTOCAD	X		
SOLIDWORKS			
DRAWN	JL	09/08/17	
CHKD	JL	09/08/17	
ENGR	AM	09/08/17	
APPR	JL	09/08/17	
TITLE:		SOLENOID COIL	
SIZE		3.5 mH, 1.5 Amps	
SCALE		N/A	
DRAWN		CWS Coil Winding Specialist.	
ENGR		353 West Grove Ave.	
APPR		Orange, CA 92865	
MFG. P/N		SOL-001416	
DESCRIPTION		REV A	