

The information contained in this drawing is the sole property of CWS Coil Winding Specialist. Any reproduction in part or whole without written permission of CWS Coil Winding Specialist is prohibited.

REVISION HISTORY

REV	ECN	DESCRIPTION	DATE	BY	CHK	DATE
A		PRE-PRODUCTION RELEASE	4/10/04	TKK	JLU	4/12/04

VERTICAL CONFIGURATION

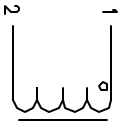

.18 [4.57]

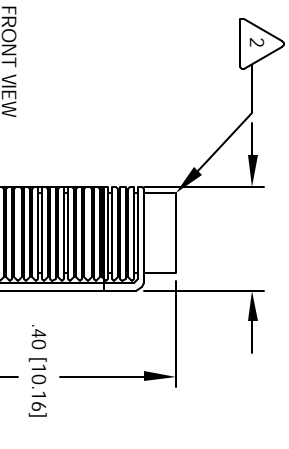

HORIZONTAL CONFIGURATION

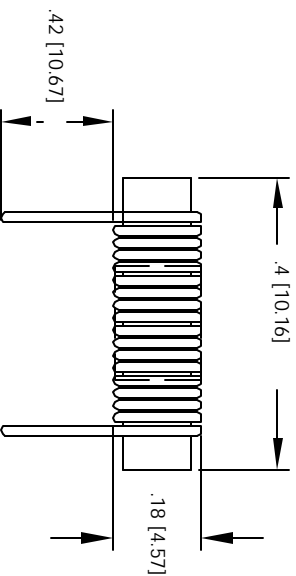

- LEADS MUST BE TANGENT TO THE CORE FLUSH WITH THE CORE EDGE, AS SHOWN
- 5 REMOVE INSULATION AND TIN LEADS

- 4 WIND COILS EVENLY SPACED
- CONSTRUCTION:

HI-POT TEST FOR CORE TO WINDING = 500 VDC

DCR = 6.5 MILLIOHMS @ 25 °C

L = 1.0 UH ± 20%, 1 KHz, 0.25 Vrms, 0 ADC;

- 3 SPECIFICATIONS: MAX DC CURRENT = 3 AMPS

WIRE: UL RECOGNIZED 130° RATED MAGNET WIRE

CWS BYTEMARK OR OTHER APPROVED PART

- 2 CORE: MANGANESE ZINC FERRITE ROD

RATING CLASS B (130°) REQUIRED

- 1 MATERIAL: WIRE INSULATION - UL RECOGNIZED 94V-0 FOR FLAMMABILITY

NOTES: UNLESS OTHERWISE SPECIFIED, POWER INDUCTOR DIMENSIONS IN INCHES [MM]

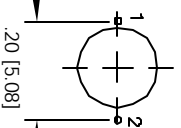

MOUNTING HOLES PATTERN

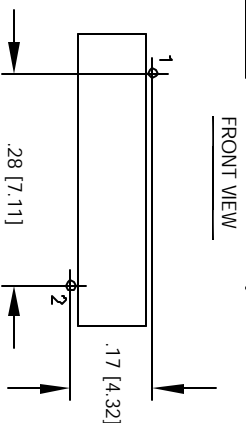

MOUNTING HOLES PATTERN

UNLESS OTHERWISE SPECIFIED
DRAWING AND TOLERANCE PER ANSI Y14.5M
ALL DIMENSIONS ARE IN INCHES AND [DIMENSIONS]
TOLERANCE INCHES: ±.0030
±.0050
TOLERANCE METERS: ±.075
±.127
ANGLE PROJECTION
DO NOT SCALE DRAWING

CODE IDENT	MFG. P/N	DESCRIPTION	ITEM NO.
AUTOCAD SIGN	X	PARTS LIST	
SOLIDWORKS SIGN		CWS Coil Winding Specialist	
DATE		1510 E. Edinger Ave	
		Unit B, Santa Ana, CA 92705	
DATE		Power Chokes	
TKK	4/10/04		
JLU	4/10/04		
JLU	4/10/04		
JLU	4/12/04		
SIZE	DRW. NO.	REV	
B	PCR0310-1R0M	A	
SCALE	2=1	SHEET	1 OF 1