

The information contained in this drawing is the sole property of CWS Coil Winding Specialist. Any reproduction in part or whole without written permission of CWS Coil Winding Specialist is prohibited.

REVISION HISTORY						
REV	ECN	DESCRIPTION	SIGN & DATE			
			BY	DATE	CHK	DATE
A		PRODUCTION RELEASE	TDK	8/23/05	JLAU	8/23/05
B		REVISED DIMENSION AND UPDATE DWG	KLC	3/27/09	AM	3/27/09
C		UPDATED	RCL	7/6/11	JLAU	7/6/11

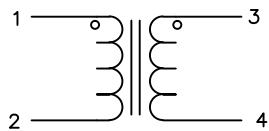

SCHEMATIC

7 BUILT TO RoHS COMPLIANCE AN LEAD FREE

WHERE SHOWN, USING A PERMANENT MARKING METHOD MARK PART NUMBER AND REVISION IN APPROX WRAP INDUCTOR WITH TAPE, (PER NOTE 2)

TO THE CORE MUST REST FLAT ON PCB). LEADS MUST BE TANGENT FLUSH WITH THE COIL EDGE, AS SHOWN (I.E. COIL REMOVE INSULATION AND TIN LEADS APPROX. 0.40 INCH

CORE AND EVENLY SPACED, NOTE POLARITY WIND SINGLE LAYER ON EACH SIDE TO CONSTRUCTION:

OPERATING RANGE: -40 °C to 85 °C
 TO INSURE INTERGRITY OF WINDING SEPARATION HI-POT TEST FOR INTERWINDING ISOLATION =250VDC
 POWER LOSS= 6.4 W MAX.@ 40A/COIL
 DCR= 2 mOHMS MAX./COIL, MEASURED USING QUADTECH 2200
 L= 550 uH NOM/COIL, (1KHZ, 1Vrms)

3 SPECIFICATIONS @ 25 °C :

OUTER WRAP: 3M #69 OR EQUAL
 WIRE: UL RECOGNIZED CLASS 180°C RATING MAGNET WIRE OR HIGHER
 CWS BYTEMARK OR OTHER APPROVED PART
 CORE: COATED FERRITE TOROID, HIGH PERM MNZN

BUILD TO CLASS B (130°C) INSULATION
 1 MATERIAL: UL RECOGNIZED 94V-0 FOR FLAMMABILITY

NOTES: UNLESS OTHERWISE SPECIFIED.READ FROM BOTTOM UP.

CAGE CODE = 5DME2

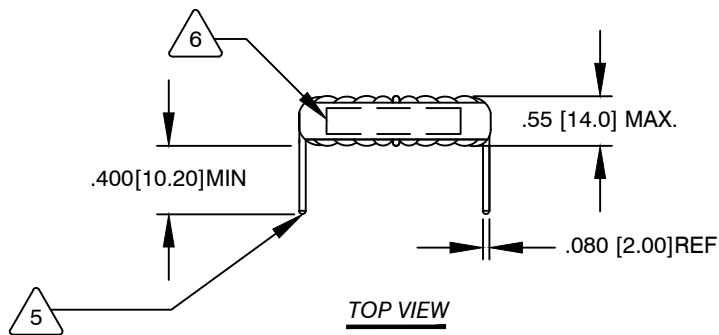

TOP VIEW

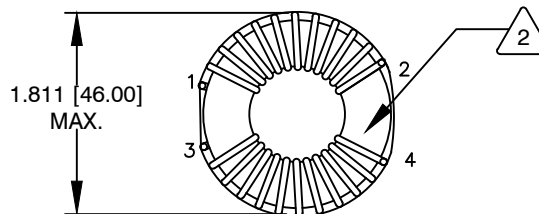

BOTTOM VIEW

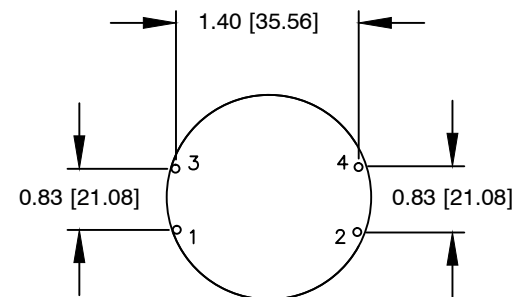

MOUNTING HOLES PATTERN

QTY	CODE IDENT	MFG. P/N	DESCRIPTION	ITEM NO.
PARTS LIST				
AUTOCAD		X		
SOLIDWORKS				
SIGN		DATE	COILWS COM, INC	CWS Coil Winding Specialist.
DRAWN	TDK	8/23/05	www.coilws.com	353 W Grove Ave Orange, CA 92865
CHECKED	JLAU	8/23/05	TITLE: Inductor Common Mode 550uH 40A	
ENGR.	KSUM	8/23/05		
APPR.	JLAU	8/23/05		
SIZE	DWG. NO.		C-36A29-03	REV C
B				
SCALE		1=1		SHEET 1 OF 1

UNLESS OTHERWISE SPECIFIED	
DIMENSIONING AND TOLERANCE PER ANSI Y14.5M	
ALL DIMENSIONS ARE IN INCHES AND [MILIMETERS].	
TOLERANCE INCHES: .XXX=±.010 .XX=±.020 $\angle = \pm 0^{\circ}30'$	
TOLERANCE METRICS: .XXX=±.254 .XX=±.51 $\angle = \pm 0^{\circ}30'$	
ANGLE PROJECTION	
DO NOT SCALE DRAWING	

CAD-FILE: