

The information contained in this drawing is the sole property of CWS Coil Winding Specialist. Any reproduction in part or whole without written permission of CWS Coil Winding Specialist is prohibited.

REVISION HISTORY

REV	ECN	DESCRIPTION	BR	DATE	CHK	DATE
C		PRODUCTION RELEASE	TDK	12/07/04	JLJU	12/07/04
D		REVISED DIMENSION AS SAME AS K69XXXXXXXX8-A01	RL	12/4/06	JLJU	12/4/06
E		ADDED NOTE #8, 9, 10, AND 11	KLC	9/23/08	RL	9/23/08
G1	552020	LIMITED VARNISH OPTIONS	TN	05/05/2020	JL	05/05/2020

- 11 BUILD TO ROHS COMPLIANCE AND LEAD FREE
- 10 OR OVEN CURED AS REQUIRED  
DIP-VANISH WITH BC-346-A AND OVEN DRY
- 9 THIS IS CRITICAL MAXIMUM DIMENSION
- 8 BOTTOM OF CORE TO START OF TINNING  
6.5±0.5 MM DIMENSION MEASURED FROM
- 7 TOP OF CORE TO START OF TINNING  
13.5 MM DIMENSION MEASURED FROM
- 6 USING A PERMANENT MARKING METHOD  
MARK PART NUMBER AND REVISION  
WRAP INDUCTOR WITH TAPE, (PER NOTE 2)
- 5 TO THE CORE  
MUST REST FLAT ON PCB, LEADS MUST BE TANGENT  
FLUSH WITH THE COIL EDGE, AS SHOWN (I.E. COIL  
REMOVE INSULATION AND TIN LEADS 7.0 MM MIN
- 4 SIDE OF CORE AND EVENLY SPACED, POLARITY NOTED  
WIND 4 TURNS, .091x .182 RECT. SINGLE LAYER ON EACH  
CONSTRUCTION:
- 3 TO INSURE INTERGRITY OF WINDING SEPARATION  
HI-POT TEST FOR INTERWINDING ISOLATION= 250VDC  
POWER LOSS= 5.2 W MAX.@ 90A/COIL  
DCR= .40 MOHMS MAX./COIL  
L= 52 uH MIN / COIL, 70 uH NOM / COIL, 1 KHZ, 1Vrms  
SPECIFICATIONS @ 25°C:

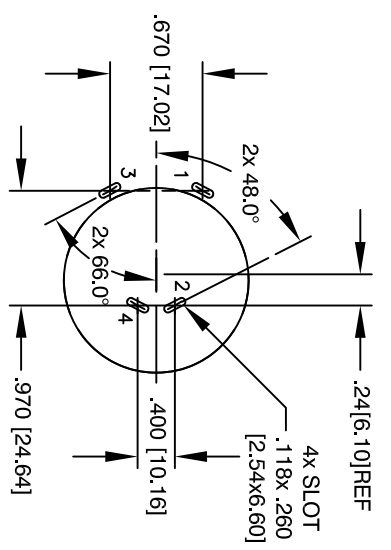
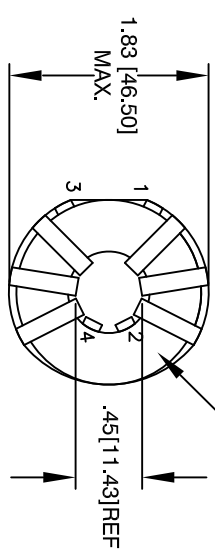
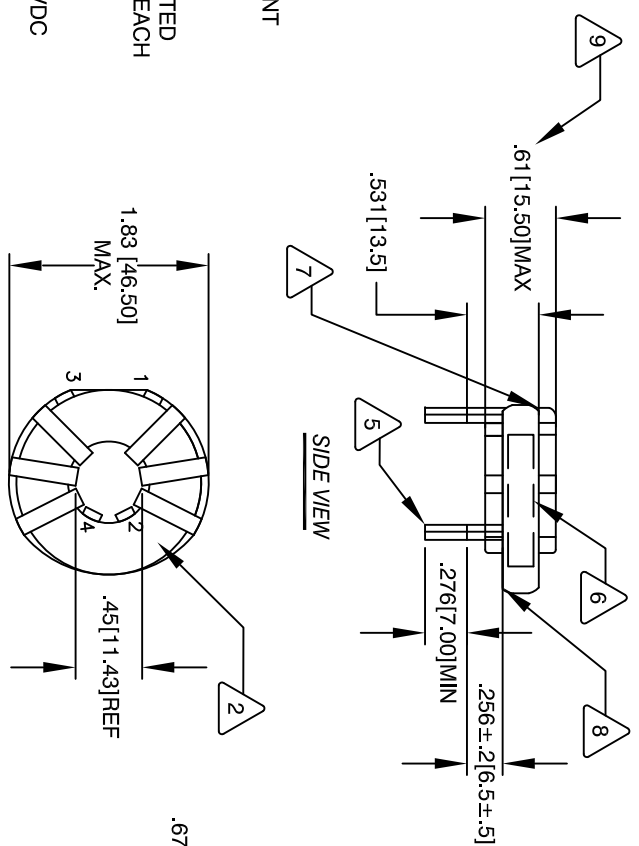

- 2 APPROVED PART  
OUTER WRAP: 3M #11 OR #69 OR OTHER CWS  
WIRE: UL RECOGNIZED 200°C RATING MAGNET WIRE  
CWS BYTEMARK OR OTHER APPROVED PART  
CORE: RATED 6000 VOLT FERRITE TOROID INSULATION, HIGH PERM MNZN
- 1 CLASS B (130°C) REQUIRED  
MATERIAL: UL RECOGNIZED 94V-0 FOR FLAMMABILITY

NOTES: UNLESS OTHERWISE SPECIFIED, READ FROM BOTTOM UP

QTY	CODE	IDENT	MFG. P/N	DESCRIPTION	ITEM NO.
				<b>PARTS LIST</b>	
	AUTOCAD	SOLIDWORKS			
	DRWN	TKK	DATE		
	ENGR	KSUM	DATE		
	APPR	JLJU	DATE		
			TITLE:		
			Inductor Common Mode		
			70uH 90A		
			SIZE (Dwg. No.)		
			B C-36A29-06-B		
			SCALE		
			1=1		
			SHEET 1 OF 1		

UNLESS OTHERWISE SPECIFIED  
DIMENSIONING AND TOLERANCE PER ANSI Y14.5M  
AND [MILLIMETERS].  
TOLERANCE INCHES:  
XXX±.010 XX±.020 X±.030  
XXX±.25 X±.51  
ANGLE PROJECTION