

The information contained in this drawing is the sole property of CWS Coil Winding Specialist. Any reproduction in part or whole without written permission of CWS Coil Winding Specialist is prohibited.



- 7 BUILD TO RoHS COMPLIANCE AND LEAD FREE
LABEL PART NUMBER, REVISION AND DATE CODE
WRAP INDUCTOR WITH GLASS TAPE

- 6 TO THE CORE
MUST REST FLAT ON PCB, LEADS MUST BE TANGENT
FLUSH WITH THE COIL EDGE, AS SHOWN (I.E. COIL
REMOVE INSULATION AND TIN LEADS TO SPECIFIED DIM SHOWN,
WIND COIL EVENLY SPACED AROUND THE CORE
CONSTRUCTION:

- 5 WEIGHT: 146 GRAMS TYPICAL
HIPOT TEST FOR WINDING TO CORE ISOLATION = 1000VDC, 2mA, 2s.
OPERATING TEMP. RANGE = -40°C TO 155°C
CURRENT RATING : 15 AMPS
INTERWINDING CAPACITANCE = 55pF TYP @ SRF
|Z| = 15.7 KILO-OHMS TYP. @ SRF
SRF = 1MHz TYPICAL
DCR = 25.0 MILLIOHMS MAX.
INDUCTANCE @ DC BIAS: SEE TABLE ON THE RIGHT.
INDUCTANCE = 472uH ± 15% @ 0A DC BIAS, 1KHz, 250mV
SPECIFICATIONS @ 25°C:

- 4 WIRE: UL RECOGNIZED 200°C RATED MAGNET WIRE or HIGHER
CORE: POWDERED TOROIDAL CORE

- 2 RATING CLASS H (180°C MIN.) REQUIRED
1 MATERIAL: UL RECOGNIZED 94V-0 FOR FLAMMABILITY
- ANY TOLERANCE. THIS DIM. CAN VARY A LITTLE FROM PART TO PART.
"TYP" IN DIM. TOL. REFERS TO A NON-CRITICAL TYPICAL (AVERAGE) DIM. WITHOUT
NOTES: UNLESS OTHERWISE SPECIFIED, READ NOTES FROM BOTTOM UP.
CAGE CODE: 5DME2

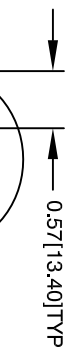
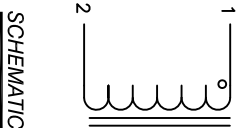
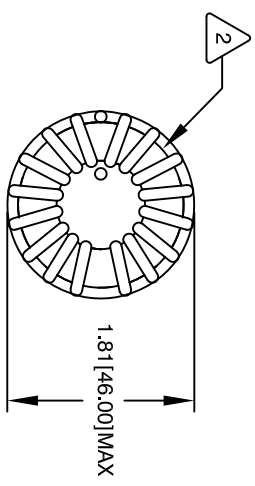
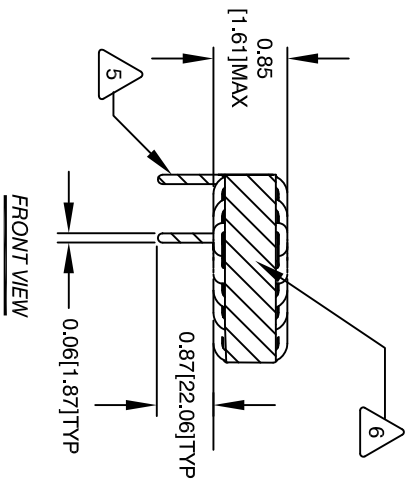

DC BIAS TABLE

DC BIAS (AMP)	L@10KHz (REF)
0	479uH
2	443uH
4	375uH
6	295uH
8	216uH
10	154uH
12	110uH
15	69uH

REVISION HISTORY		SIGN & DATE				
REV	ECN	DESCRIPTION	BY	DATE	CHK	DATE
A		INITIAL DRAWING RELEASE	TN	12/07/2020	JL	12/07/2020

CODE IDENT	MFG. P/N	DESCRIPTION	ITEM NO.
PARTS LIST			
AUTOCAD SOLIDWORKS SIGN	X	COLIWS COIL, INC www.coliws.com	CWS Coil Winding Specialist. 353 W Grove Ave Orange, CA 92865
DATE	DATE	TITLE:	
12/07/2020	12/07/2020	Power Inductor	
12/07/2020	12/07/2020	472uH, 15 Amps	
ENGR. JL	12/07/2020	SIZE DIM. NO.	
APPR. JL	12/07/2020	B CWS-1MP-11849	REV A
DO NOT SCALE DRAWING	SCALE	2=1	SHEET 1 OF 1