

The information contained in this drawing is the sole property of CWS Coil Winding Specialist. Any reproduction in part or whole without written permission of CWS Coil Winding Specialist is prohibited.

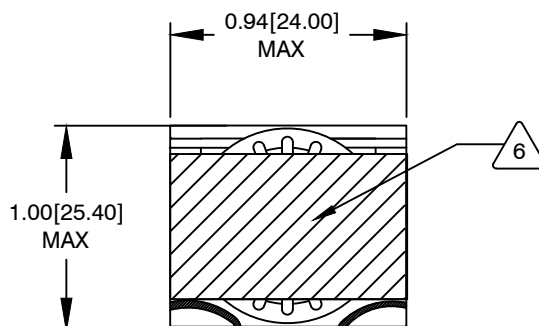

REVISION HISTORY						
REV	ECN	DESCRIPTION	SIGN & DATE			
			BY	DATE	CHK	DATE
A		PRODUCTION RELEASE	KLC	5/24/12	AK	5/24/12
A1		INITIAL DRAWING RELEASE	TN	10/18/2020	JL	10/18/2020

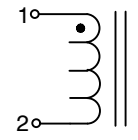
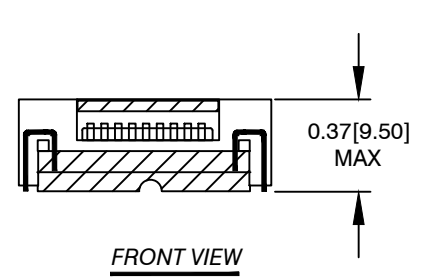

**SCHEMATIC**

7 BUILT TO RoHS COMPLIANCE AND LEAD FREE.

6 MARK PART NUMBER, REVISION AND DATE CODE

OVER. LEADS TERMINATION IS ON THE OTHER SIDE OF CASE THEN BEND BOTH LEADS ALONG CASE'S BOTTOM SIDE AND BEND KEEPING LEADS WITH APPROPRIATE LENGTH, STRIP AND TIN WIND ON TO CORE AND EVENLY SPACED

4 CONSTRUCTION:

WEIGHT: 13 GRAMS TYPICAL  
 HI-POT TEST FOR WINDING TO WINDING = 300 VDC MIN.  
 RECOMMENDED OPERATING TEMP. RANGE: -40°C TO 130°C  
 RATED CURRENT = 15.4 AMPS MAX.  
 DCR = 6.20 MILLI-OHMS MAX.  
 INDUCTANCE AT DC BIAS: SEE TABLE ON THE RIGHT  
 INDUCTANCE = 10.5uH NOM @ 1KHz, 250mV, 0ADC BIAS

3 SPECIFICATIONS @ 25°C:

PLASTIC CASE  
 WIRE: UL RECOGNIZED 130°C RATING MAGNET WIRE  
 CORE: POWDERED TOROIDAL CORE

1 MATERIAL: UL RECOGNIZED 94V-0 FOR FLAMMABILITY

WITHOUT ANY TOLERANCE. THIS DIM. CAN VARY A LITTLE FROM PART TO PART. "TYP" IN DIM. TOL., IF APPLICABLE, REFERS TO A NON-CRITICAL TYPICAL (AVERAGE) DIM.

NOTES: UNLESS OTHERWISE SPECIFIED, READ NOTES FROM BOTTOM UP.  
 CAGE CODE: 5DME2

5

**TOP VIEW**

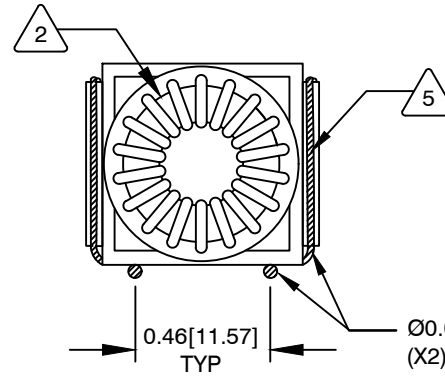

**BOTTOM VIEW**

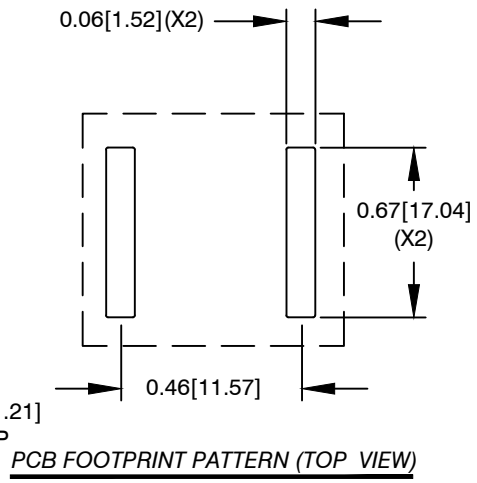

**PCB FOOTPRINT PATTERN (TOP VIEW)**

**DC BIAS TABLE**

DC BIAS (AMP)	L@1KHz (REF)
0	10.0uH
2	9.8uH
4	9.2uH
6	8.2uH
8	7.4uH
10	6.7uH
12	6.0uH
15	5.2uH
15.4	5.0uH

QTY	CODE IDENT	MFG. P/N	DESCRIPTION	ITEM NO.
<b>PARTS LIST</b>				
AUTOCAD		X		
SOLIDWORKS				
SIGN		DATE	<a href="mailto:sales@coilws.com">sales@coilws.com</a> <a href="http://www.coilws.com">www.coilws.com</a>	
DRAWN	KLC	5/24/12	Coil Winding Specialist, Inc. 353 W. Grove Avenue Orange, CA 92865	
CHECKED	AK	5/24/12		
ENGR.	JLAU	5/24/12		
APPR.	KLC	5/24/12		
TITLE:			Power Inductor	
SIZE			10uH, 15.4 Amps, SMD	
DWG. NO.			CWS-1TC-12142	
SCALE			NOT_TO_SCALE	REV A1
SHEET 1 OF 1				

UNLESS OTHERWISE SPECIFIED  
 DIMENSIONING AND TOLERANCE PER ANSI Y14.5M  
 ALL DIMENSIONS ARE IN INCHES AND [MILLIMETERS].  
 TOLERANCE INCHES:  
 .XXX=±.010 .XX=±.015 <math>\angle=±0°30'</math>  
 TOLERANCE METRICS:  
 .XXX=±.254 .XX=±.38 <math>\angle=±0°30'</math>  
 ANGLE PROJECTION   
 DO NOT SCALE DRAWING