

The information contained in this drawing is the sole property of Coil Winding Specialist, Inc. Any reproduction in part or whole without written permission of Coil Winding Specialist, Inc. is prohibited.

REVISION HISTORY

REV	ECN	DESCRIPTION	BY	DATE	CHK	DATE
A		PRODUCTION RELEASE	RCL	6/22/11	JCL	3/21/11
B		UPDATED ELECTRICAL SPEC.	TR	11/19/18	JL	11/19/18

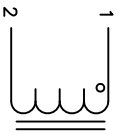

SCHEMATIC

- 8 NOISE FILTER APPLICATION: ENERGY STORAGE FILTER, SWINGING CHOKES
- 7 BUILT TO ROHS COMPLIANCE AND LEAD FREE.

- 6 MARK PART NUMBER AND REVISION WHERE SHOWN
- 5 VANISH PART AND CURE APPLY SILICON WHERE SHOWN

- 4 WRAP TAPE AROUND CORES WITH CORES AND NOMEX SPACERS ASSEMBLE PRE FORMED FLAT HELICAL COIL CONSTRUCTION

- 3 VANISH DOLPH OR EQUAL SILICON DOW CORNING OR EQUAL NOMEX SPACERS FOR SIDE AND CENTER LEG OF CORES OUTER WRAP: 3M GLASS OR EQUAL WIRE: UL RECOGNIZED 200°C RATED MAGNET WIRE CORE: COMPACTED POWDERED CORE

- 2 INSULATION CLASS 200°C REQUIRED MATERIAL: UL RECOGNIZED 94V-0 FOR FLAMMABILITY

CAGE NO: 5DME2

NOTES: UNLESS OTHERWISE SPECIFIED, READ FROM BOTTOM UP.

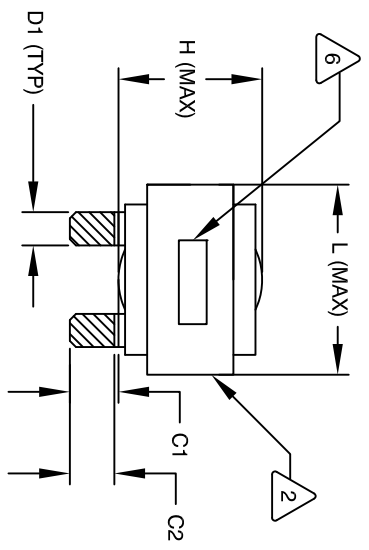

FRONT VIEW

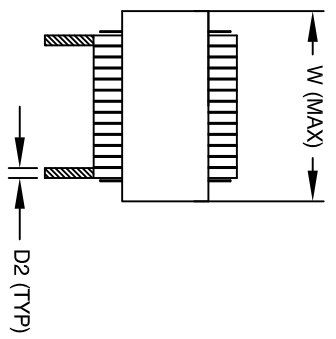

SIDE VIEW

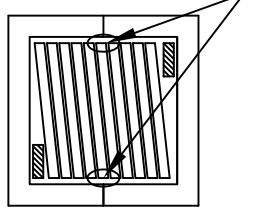

BOTTOM VIEW

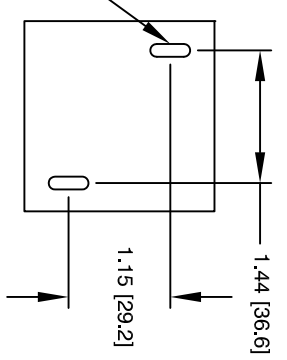

MOUNTING HOLES PATTERN

DIMENSIONAL TOLERANCE

	mm	Inch
C1	13.96±1.50	0.55 ± 0.06
C2	11.41±1.00	0.45 ± 0.04
D1	7.0 (TYP)	0.28 (TYP)
D2	0.7 (TYP)	0.03 (TYP)
L	58.0 MAX	2.29 MAX
W	58.0 MAX	2.29 MAX
H	35.0 MAX	1.37 MAX

DC-BIAS	L
0A	372.2uH
5A	334.7uH
10A	272.8uH
15A	210.7uH
20A	160.4uH
25A	129.1uH
27A	120.0uH

QTY	CODE IDENT	MFG. P/N	DESCRIPTION	ITEM NO.
			PARTS LIST	
			www.coilw.com	
			353 W. GROVE AVE	
			ORANGE, CA 92665	
			Coil Winding Specialist, Inc.	
			TITLE:	
			High Current Helical Inductor	
			340 uH, 27 Amps, Horizontal	
			SIZE Dwg. NO.	
			ESS55246-341M-27AH	
			SCALE	
			NOT_TO_SCALE	
			SHEET	
			1 OF 1	

UNLESS OTHERWISE SPECIFIED
 DIMENSIONING AND TOLERANCE PER ANSI Y14.5M
 ALL DIMENSIONS ARE IN INCHES AND [MILLIMETERS].
 TOLERANCE INCHES: $\phi = \pm 0.30$
 .XXX-±0.10 .XX-±0.20
 TOLERANCE METRCS: $\phi = \pm 0.30$
 .XXX-±.254 .XX-±.51
 ANGLE PROJECTION
 DO NOT SCALE DRAWING