

The information contained in this drawing is the sole property of Coil Winding Specialist Inc. (CWS) Any reproduction in part or whole without written permission of CWS is prohibited.

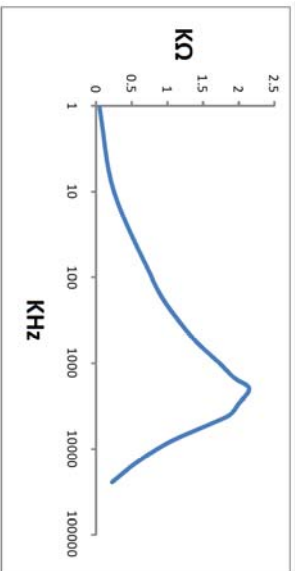

DIMENSIONAL TOLERANCE INCHES [MM]

A(OD) Max	B(WIDTH) Max	C(LEAD) Min	D(LEAD DIA) TYP	E (Min/Max)	P1 Ref	P2 Ref
0.87	0.57	0.50	0.03		0.33	0.49
[22.06]	[14.57]	[12.7]	[0.80]		[8.30]	[12.50]

REVISION HISTORY

REV	ECN	DESCRIPTION	BY	DATE	CHK	DATE
A.1	1	PRODUCTION RELEASE	RCL	7/1/11	JLU	7/1/11
B	2	PRODUCTION RELEASE	AK	11/23/11	JLU	11/23/11

6 BUILT TO ROHS COMPLIANCE AND LEAD FREE.

5 MARK PART NUMBER AND REVISION.

4 TIN LEADS APPROX. 0.5 INCH AND FLUSH WITH THE COIL EDGE.

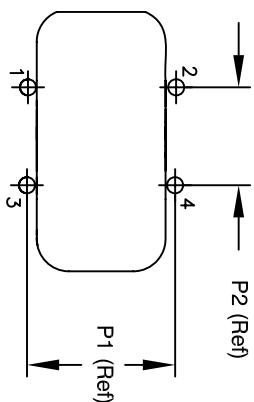
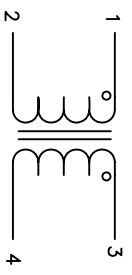
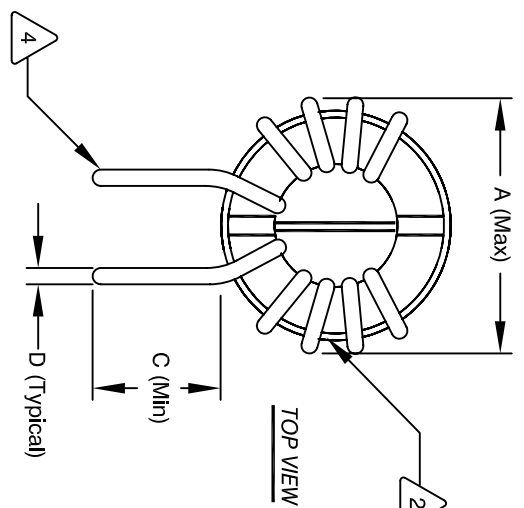

- WEIGHT = 11.0 GRAMS (TYP)
- OPERATING TEMP RANGE = -25 °C TO 120°C
- MAX TEMP RISE = 40 °C
- INTERWINDING ISOLATION = 2000 VOLTS RMS.
- DCR ON EACH WINDING = 25.0 mΩ MAX.
- SRF = 2.7 MHZ NOM
- RATED VOLTAGE = 250 VAC OR VDC
- RATED CURRENT = 4 AMPS
- LEAKAGE INDUCTANCE = 10.8 uH TYP @ 10 KHZ, 1 Vrms.
- INTERWINDING CAPACITANCE = 1.12 pF TYP @ 10KHZ.
- IMPEDANCE @ SRF = 1.5 KΩ (TYP)
- L = 4.0 mH MIN @ 1 KHZ, 1 Vrms, 0 ADC
- INSULATION RESISTANCE = 100 MEGA-OHMS MIN. @ 500 VDC
- SPECIFICATIONS AT 25°C:

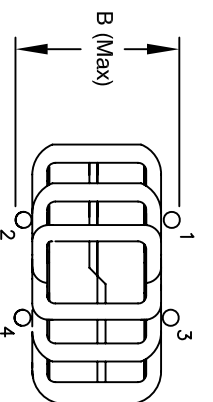

BOTTOM VIEW

- WIRE: UL RECOGNIZED 200°C RATED MAGNET WIRE
- CWS BYTE-MARK OR OTHER APPROVED PART
- CORE: NANOCRYSTALLINE OR AMORPHOUS CORE

- BOBBIN RATING CLASS B (130°) REQUIRED
- 1 MATERIAL: UL RECOGNIZED 94V-0 FOR FLAMMABILITY
- NOTES: UNLESS OTHERWISE SPECIFIED, READ NOTES FROM BOTTOM TO TOP.
- CAGE CODE = 5DME2

UNLESS OTHERWISE SPECIFIED	
DIMENSIONING AND TOLERANCE PER ANSI Y14.5M AND [UNITS/METERS]	DRWN: RLUJ
TOLERANCE INCHES: .XXX=±.005 .XX=±.015 .X=±.030	ENGR: JLUJ
TOLERANCE METRICS: .XXX=±.127 .XX=±.38 .X=±.8	APPR: JLUJ
ANGLE PROJECTION	DO NOT SCALE DRAWING

QTY	CODE IDENT	MFG. P/N	DESCRIPTION	ITEM NO.
<b>PARTS LIST</b>				
AUTOCAD SOLIDWORKS SIGN		www.coilw.com sales@coilw.com Coil Winding Specialist Inc. 353 West Grove Ave Orange, California, 92865		
DATE	DATE	TITLE: Nanocrystalline Inductor Common Mode Chokes Vertical Mount		
12/16/10	12/16/10	SIZE	DWG. NO.	REV
		B	GN-V-502U-4A	B
SCALE		2=1		SHEET 1 OF 1