

The information contained in this drawing is the sole property of CWS Coil Winding Specialist. Any reproduction in part or whole without written permission of CWS Coil Winding Specialist is prohibited.

DIMENSIONAL TOLERANCES (INCHES [MM])					
A	B	C	D	X	Y
M/AX	M/AX	M/IN	REF	REF	REF
1.83 [46.5]	.874 [22.2]	.75 [19.05]	.06 [1.52]	1.75 [44.45]	.787 [20.0]

REVISION HISTORY			
REV	ECN	DESCRIPTION	DATE
--		INITIAL PRODUCTION RELEASE	

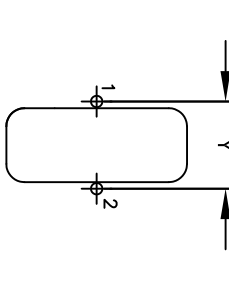
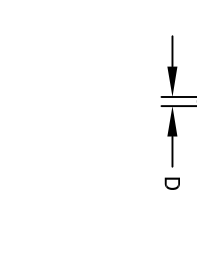
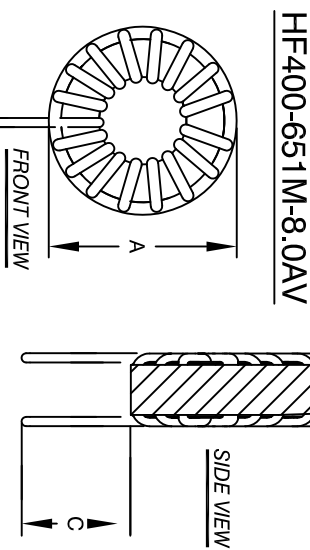
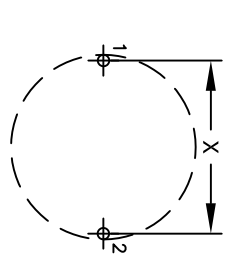
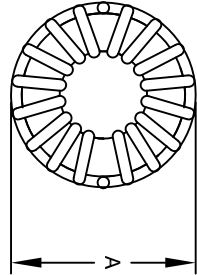
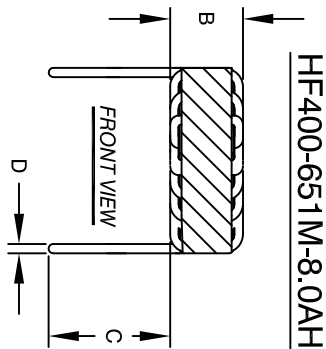

- BUILT TO ROHS COMPLIANCE.
- IF APPLICABLE, LABEL PART NUMBER AND REVISION POSITION LEADS AS REQUIRED
- REMOVE WIRE INSULATION AND TIN WIND COILS EVENLY SPACED
- CONSTRUCTION:
- WEIGHT: ~130 GRAMS
- HI-POT WINDING-TO-CORE 1250 V AC, 10 SEC INTERWINDING CAPACITANCE 70pF TYPICAL @ SRF
- DCR = 50mΩ MAX
- SRF ~ 832.5kHz TYPICAL
- MAX TEMP: RISE @ IDC 8 AMP, LESS THAN 50°C WITH NO AIRFLOW
- DC BIASED = 5.0 AMPS, INDUCTANCE = 430 UH
- DC BIASED = 8.0 AMPS, INDUCTANCE = 330 UH
- INDUCTANCE @ 0 AMP = 650uH±15% (LESS THAN 10% RIPPLE)
- TEST FREQUENCY: 1.0 KHZ ; TEST VOLTAGE: 250mV
- RATED MAX. CURRENT = 8 AMPS RMS ; FREQUENCY: 1KHZ
- OPERATING TEMPERATURE RANGE : -40° TO 180°C
- SPECIFICATIONS @ 25°C
- WIRE: UL RATED CLASS 200°C
- CORE: HIGH TEMP POWDERED CORE
- RATING UL-CLASS H (180°C) REQUIRED
- MATERIAL: UL RECOGNIZED FLAMMABILITY

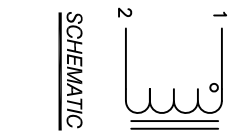

CODE IDENT	MFG. P/N	DESCRIPTION	ITEM NO.
AUTOCAD	X		
SOLIDWORKS			
DRAWN	8/6/08		
CHECKED	8/6/08		
ENGR.	8/6/08		
APPR.	8/6/08		

UNLESS OTHERWISE SPECIFIED	DIMENSIONING AND TOLERANCE PER ANSI Y14.5M
ALL DIMENSIONS ARE IN INCHES AND [MILLIMETERS]	
TOLERANCE INCHES:	∅ = +0.030
.XXX±.005 .XX±.015	
TOLERANCE METRICS:	∅ = +0.30
.XXX±.127 .XX±.38	
ANGLE PROJECTION	AS SHOWN
DO NOT SCALE DRAWING	

PARTS LIST		CWS Coil Winding Specialist.	
COILWS COM, INC		353 WEST GROVE	
WWW.COILWS.COM		ORANGE, CA 92865	
TITLE: Toroidal Power Inductor			
SIZE	UNC. NO.	REV	
B	HF400-651M-8.0A	--	
SCALE	2=1	SHEET	1 OF 1