

The information contained in this drawing is the sole property of CWS Coil Winding Specialist. Any reproduction in part or whole without written permission of CWS Coil Winding Specialist is prohibited.

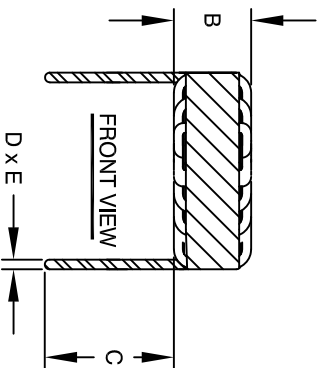

DIMENSIONAL TOLERANCES INCHES (MM)					
A	B	C	D	E	X
MAX	MAX	MIN	REF	REF	REF
2.20	1.00	0.75	0.18	0.09	2.12
[56.00]	[25.40]	[19.00]	[4.50]	[2.20]	[54.00]

REVISION HISTORY				SIGN & DATE		
REV	ECN	DESCRIPTION	BY	DATE	CHK DATE	
B	-	UPDATE SPECIFICATIONS	TN	10/31/2017	JL	10/31/2017
C	-	UPDATE SPEC.	TI	06/17/2020	JL	06/17/2020

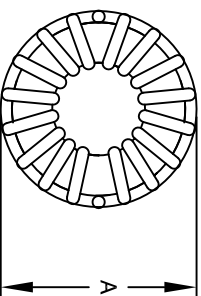
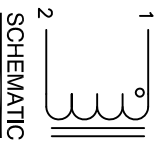

DC BIAS TABLE	
DC BIAS (AMP)	L @ 1.0 KHz
0	27uH
10	26uH
20	26uH
30	25uH
35	24uH
40	24uH
45	23uH

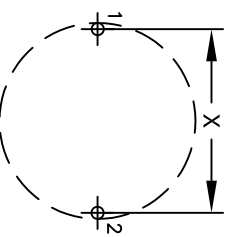

- BUILD TO ROHS COMPLIANCE AND LEAD FREE.  
USING A PERMANENT MARKING METHOD  
MARK PART NUMBER AND REVISION. IF APPLICABLE  
WRAP INDUCTOR WITH 3M # 79 OR EQUAL
- (I.E. COIL MUST REST FLAT ON PCB). LEADS MUST BE TANGENT TO THE CORE  
REMOVE INSULATION AND TIN LEADS 0.50 INCH, FLUSH WITH THE COIL EDGE, AS SHOWN
- WIND COILS EVENLY SPACED AROUND THE CORE  
CONSTRUCTION:  
THESE SPECIFICATIONS ARE BASED ON LOW RIPPLE CURRENT  
WEIGHT: 227 GRAMS TYPICAL  
INTERWINDING CAPACITANCE = 8.44pF TYP @ SRF  
SRF = 10MHZ TYPICAL  
 $|Z| = 3.67$  KILLO-OHMS TYP @ SRF  
RECOMMENDED AMBIENT OPERATING TEMP: -40°C TO 125°C  
HIPOT TEST FOR WINDING TO CORE ISOLATION = 1250 VDC 10 SEC  
CURRENT RATING : 45 AMPS, 40°C TEMP. RISE WITH SOME AIR FLOW  
DCR = 3.0 MILLI-OHMS MAX.  
INDUCTOR DC BIAS: SEE TABLE ON THE RIGHT  
INDUCTANCE =  $26\mu H \pm 15\%$  @ 0 AMP DC BIAS, 1.0 KHz, 300mV  
SPECIFICATIONS @ 25°C :

- WIRE: UL RECOGNIZED 200°C RATED MAGNET WIRE  
CORE: POWDERED TOROIDAL CORE, CWS BYTEMARK OR OTHER APPROVED PART
- MATERIAL: UL RECOGNIZED 94V-0 FOR FLAMMABILITY, RATING CLASS (200°C MIN.) REQUIRED  
ANY TOLERANCE. THIS DIM. CAN VARY A LITTLE FROM PART TO PART.  
\*TYP\* IN DIM. TABL. TABLE REFERS TO A NON-CRITICAL TYPICAL (AVERAGE) DIM. WITHOUT  
NOTES: UNLESS OTHERWISE STATED, READ NOTES FROM BOTTOM UP.  
CAGE CODE: 5DME2

UNLESS OTHERWISE SPECIFIED	
DIMENSIONING AND TOLERANCE PER ANSI Y14.5M AND (MILLIMETERS):	
TOLERANCE INCHES:	$\phi$ - $\pm 0.30$
.XXX = ±.005 XX = ±.015	
TOLERANCE METRICS:	$\phi$ - $\pm 0.30$
.XXX = ±.127 XX = ±.38	
ANGLE PROJECTION	
DO NOT SCALE DRAWING	

CODE IDENT	MFG. P/N	DESCRIPTION	ITEM NO.
<b>PARTS LIST</b>			
AUTOCAD	X	CWS Coil Winding Specialist.	
SOLIDWORKS		353 W Grove Ave Orange, CA 92865	
DRWING	TN	DATE	10/04/2017
CHKD	JL	DATE	10/04/2017
ENGR.	AM	DATE	10/04/2017
APPR.	JL	DATE	10/04/2017
TITLE:		SIZE	DWG. NO.
TOROIDAL POWER INDUCTOR		B	HF467-260M-45AH
26 uH, 45 Amps, Horizontal		SCALE	2=1
		SHEET	1 OF 1