

The information contained in this drawing is the sole property of CWS Coil Winding Specialist. Any reproduction in part or whole without written permission of CWS Coil Winding Specialist is prohibited.



DIMENSIONAL TOLERANCES INCHES [MM]					
A	B	C	D	E	X
MAX 2.89 [73.50]	MAX 3.11 [79.00]	MIN 2.56 [65.00]	REF 0.102 [2.60]	MIN 1.44 [36.50]	REF 2.83 [72.00]

REVISION HISTORY		SIGN & DATE				
REV	ECN	DESCRIPTION	BY	DATE	CHK	DATE
A			TN	10/10/17	JL	10/10/17

DC BIAS (Amp)	Inductance (μH)
0	1000
5	1000
10	970
15	870
20	830
25	740
30	640
35	550
40	510

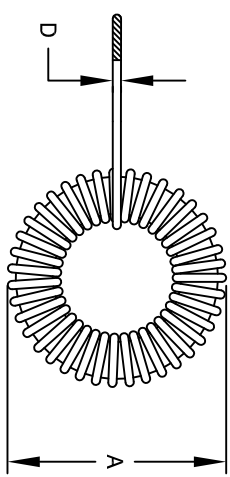

BOTTOM VIEW

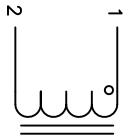

SCHEMATIC

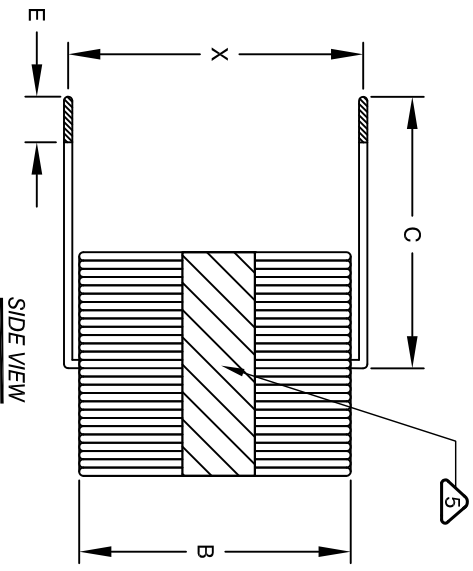

SIDE VIEW

- 8 BUILT TO ROHS COMPLIANCE.
- 7 WEIGHT: 1.195 GRAMS
- 5 LABEL PART NUMBER, REVISION AND DATE CODE
- LEADS AS REQUIRED
- REMOVE WIRE INSULATION AND TIN
- WIND COILS EVENLY SPACED
- 4 CONSTRUCTION:

- HI-POT WINDING-TO-CORE 1250 VAC, 10 SEC
- INTERWINDING CAPACITANCE = 60pF
- SFR = 630 KHZ
- |Z| @ SFR = 47 KΩ
- DCR = 27 mΩ MAX
- MAX TEMP. RISE @ 25 AMP = <50°C, NO AIRFLOW
- INDUCTANCE @ 0 AMP = 1mH±15% (LESS THAN 10% RIPPLE)
- TEST FREQUENCY: 1.0 KHZ; TEST VOLTAGE: 250mV
- INDUCTOR RATED MAX. CURRENT = 42 AMPS RMS
- INDUCTOR OPERATING TEMPERATURE RANGE: -40° TO 180°C
- 3 SPECIFICATIONS @ 25°C
- WIRE: UL RATED CLASS 200°C
- 2 CORE: HIGH TEMP POWDERED CORE

- 1 MATERIAL: UL RECOGNIZED FLAMMABILITY

NOTES: UNLESS OTHERWISE SPECIFIED, READ NOTES FROM BOTTOM TO UP.

EP FORM0005 REV 3 10/01

CODE IDENT	MFG. P/N	DESCRIPTION	ITEM NO.
		PARTS LIST	
CWS Coil Winding Specialist. 353 W Grove Ave Orange, CA 92865			
TITLE: Powder Core Inductor 1mH, 42 Amps			
DRAWN: TN		DATE: 07/06/17	
CHECKED: JL		DATE: 07/06/17	
ENGR: AM		DATE: 07/06/17	
APPR: JL		DATE: 07/06/17	
SIZE: 1/8"		SCALE: NOT TO SCALE	
MATERIAL: UL RECOGNIZED FLAMMABILITY		REV: A	
WIRE: UL RATED CLASS 200°C		SHEET 1 OF 1	
CORE: HIGH TEMP POWDERED CORE			

CAD-FILE: