

The information contained in this drawing is the sole property of CMS Coil Winding Specialist. Any reproduction in part or whole without written permission of CMS Coil Winding Specialist is prohibited.

DIMENSIONAL TOLERANCES INCHES [MM]					
A	B	C	D	X	Y
MAX	MAX	MIN	REF	REF	REF
2.01 [51.000]	1.20 [30.48]	1.00 [25.4]	0.112 [2.86]	1.85 [46.99]	1.05 [26.67]

REVISION HISTORY			SIGN & DATE			
REV	ECN	DESCRIPTION	BY	DATE	CHK	DATE
A		INITIAL PRODUCTION RELEASE	TN	10/03/17	JL	10/03/17
A1		REVISED DIM. X,Y AND REMOVE DIM. E	TN	06/20/18	JL	06/20/18

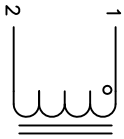

SCHEMATIC

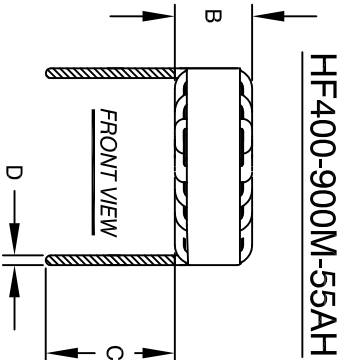

HF400-900M-55AH

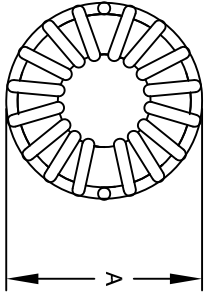

BOTTOM VIEW

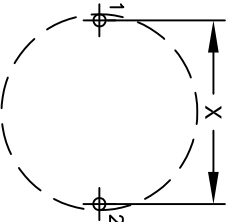

MOUNTING HOLES PATTERN

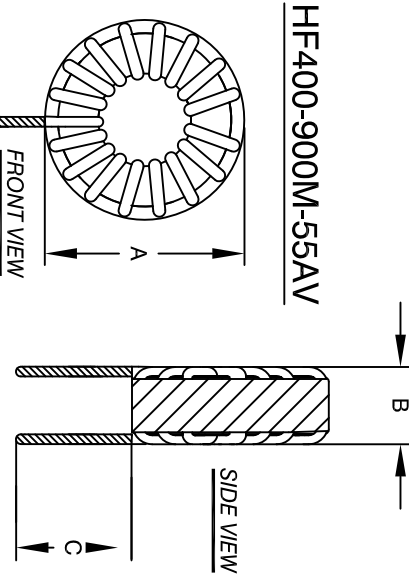

HF400-900M-55AV

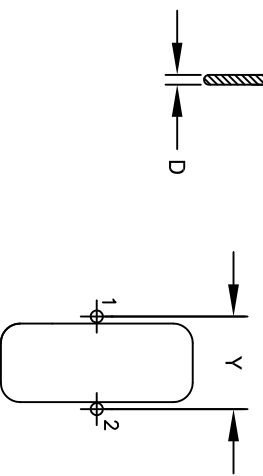

MOUNTING HOLES PATTERN

- BUILT TO ROHS COMPLIANCE.
- IF APPLICABLE, LABEL PART NUMBER AND REVISION
- POSITION LEADS AS REQUIRED
REMOVE WIRE INSULATION AND TIN
WIND COILS EVENLY SPACED
CONSTRUCTION:
- WEIGHT: ~189.5 GRAMS
- HIPOT WINDING-TO-CORE 1250 V AC; 2mA, 10 SEC
DCR = 7.0 MILLI-OHMS MAX
MAX TEMP. RISE @ IDC 55 AMPS, LESS THAN 70°C WITH NO AIRFLOW
DC BIASED = 55 AMPS, INDUCTANCE = 32.8 uH (TYP)
DC BIASED = 15 AMPS, INDUCTANCE = 81.0 uH (TYP)
INDUCTANCE @ 0 AMP = 90uH (TYP)
TEST FREQUENCY: 1.0 KHZ ; TEST VOLTAGE: 250mV
RATED MAX. CURRENT = 55 AMPS RMS ; FREQUENCY: 1KHZ
OPERATING TEMPERATURE RANGE : -40° TO 200°C
SPECIFICATIONS @ 25°C
- WIRE: UL RATED CLASS 200°C
CORE: HIGH TEMP POWDERED CORE
- RATING UL-CLASS H (180°C) REQUIRED
MATERIAL: UL RECOGNIZED FLAMMABILITY

NOTES: UNLESS OTHERWISE SPECIFIED, READ NOTES FROM BOTTOM TO UP.

CODE	IDENT	MFG. P/N	DESCRIPTION	ITEM NO.
PARTS LIST				
AUTOCAD	SIGN	DATE	TITLE:	
TN	JL	10/03/17	COILS COM, INC	
JL	JM	10/03/17	353 WEST GROVE	
JL	JL	10/03/17	ORANGE, CA 92865	
UNLESS OTHERWISE SPECIFIED			CWS Coil Winding Specialist.	
DIMENSIONING AND TOLERANCE PER ANSI Y14.5M AND [MILLIMETERS].			TOROIDAL Power Inductor	
TOLERANCE INCHES: .XX = ±0.015 .X = ±0.030 .XXX = ±0.005 .XX = ±0.015 .X = ±0.030			90 uH, 55 Amp	
TOLERANCE METRICS: .XX = ±0.25 .X = ±0.38 .XXX = ±0.127 .XX = ±0.25 .X = ±0.38			SIZE [DIM. NO.]	
ANGLE PROJECTION			HF400-900M-55.0A	
DO NOT SCALE DRAWING			SCALE	
			2=1	
			SHEET 1 OF 1	