

The information contained in this drawing is the sole property of CWS Coil Winding Specialist. Any reproduction in part or whole without written permission of CWS Coil Winding Specialist is prohibited.

DIMENSIONAL TOLERANCES INCHES [MM]

| A | B | C | D | E | F | G |
|-----------------|-----------------|------------------|-----------------|----------------|-----------------|-----------------|
| MAX | MAX | MIN | MAX | REF | MAX | MAX |
| 1.18 [30.00] | 1.81 [46.00] | 4.00 [101.60] | 1.23 [32.00] | 0.25 [6.35] | 1.04 [26.50] | 0.55 [14.00] |

REVISION HISTORY

| REV | ECN | DESCRIPTION | SIGN & DATE | | | |
|-----|-----|--------------------|-------------|----------|-----|----------|
| | | | BY | DATE | CHK | DATE |
| A | | PRODUCTION RELEASE | JL | 07/27/17 | JL | 07/27/17 |

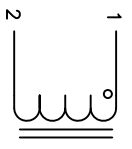

SCHEMATIC

- 10 BUILT TO ROHS COMPLIANCE.
- 9 VARNISH (REMOVE FROM TOP, BOTTOM, AND INSIDE OF BOBBIN)
- 8 LEAD LENGTH 4", STRIP END 0.25", #18 GA. WHITE TEFLON
- 7 USE SINGLE ENAMEL MAGNET COIL WIRE
- 6 BREAK AND DEBURR EDGES
- 5 IF APPLICABLE, LABEL PART NUMBER AND REVISION
- POSITION LEADS AS REQUIRED
- REMOVE WIRE INSULATION AND TIN
- WIND COILS EVENLY SPACED
- CONSTRUCTION:
- 4 FREQUENCY = 50HZ
- VOLTAGE = 115 AC
- DCR = 20Ω ±10% MAX
- SRF = 81.5 KHZ
- MAX TEMP. RISE @ IDC 0.5 AMP, LESS THAN 25°C WITH NO AIRFLOW
- INDUCTANCE = 17mH TYP.
- TEST FREQUENCY: 1.0 KHZ ; TEST VOLTAGE: 250mV
- RATED MAX. CURRENT = 0.5 AMPS RMS
- OPERATING TEMPERATURE RANGE : -40° TO 180°C
- SPECIFICATIONS @ 25°C
- 3 WIRE: UL RATED CLASS 180°C
- 2 CORE: AIR
- 1 RATING: UL-CLASS H (180°C) REQUIRED
- MATERIAL: UL RECOGNIZED FLAMMABILITY

NOTES: UNLESS OTHERWISE SPECIFIED, READ NOTES FROM BOTTOM TO UP.

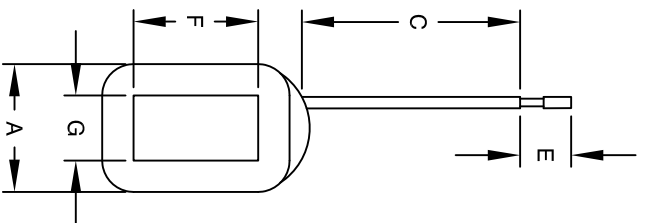

FRONT VIEW

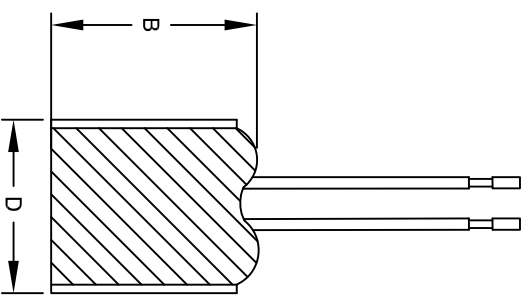

SIDE VIEW

| | |
|---|------------|
| UNLESS OTHERWISE SPECIFIED | |
| DIMENSIONING AND TOLERANCE PER ANSI Y14.5M AND [MILLIMETERS]. | |
| TOLERANCE INCHES: | ∅ = ±0.30" |
| .XXX = ±.005 XX = ±.015 | ∅ = ±0.30" |
| TOLERANCE METRICS: | |
| .XXX = ±.127 XX = ±.38 | |
| ANGLE PROJECTION | |
| DO NOT SCALE DRAWING | |

| CODE IDENT | MFG. P/N | DESCRIPTION | ITEM NO. |
|--------------------|----------|-----------------|----------|
| PARTS LIST | | | |
| AUTOCAD SOLIDWORKS | X | | |
| DRWN | JL | 07/27/17 | |
| CHKD | JL | 07/27/17 | |
| ENGR | AM | 07/27/17 | |
| APPR | JL | 07/27/17 | |
| TITLE: | | SOLENOID COIL | |
| SIZE | | 17 mH, 0.5 Amps | |
| SCALE | | N/A | |
| REV | | A | |
| SHEET | | 1 OF 1 | |

COILWS.COM, INC
www.coilws.com
CWS Coil Winding Specialist
353 West Grove Ave.
Orange, CA 92865