

The information contained in this drawing is the sole property of CWS Coil Winding Specialist. Any reproduction in part or whole without written permission of CWS Coil Winding Specialist is prohibited.

DIMENSIONAL TOLERANCE						
A	B	C	D (LEAD)	E (LEAD DIM)		X
MAX	MAX	MAX	TYP	TYP		REF
1.50*	1.50*	.72*	.50*	0.047*		1.10*
[38.0]	[38.1]	[18.3]	[12.7]	[1.20]		[28.0]

REVISION HISTORY						
REV	ECN	DESCRIPTION	SIGN & DATE			
			BY	DATE	CHK	DATE
A		INITIAL RELEASE	RPR	01/25/05	JLAU	01/25/05
B		UPDATE TO ROHS COMPLIANCE	RPR	06/20/06	JLAU	06/20/06
C		UPDATE DIMENSIONS & ADD ADDITIONAL DATA	KLC	04/13/11	AK	04/13/11

DC Bias Data (TYP)

Current	Inductance
0 Amp	480 uH
2 Amp	351 uH
4 Amp	277 uH
6 Amp	206 uH
7 Amp	175 uH
8 Amp	163 uH
9 Amp	153 uH
10 Amp	137 uH

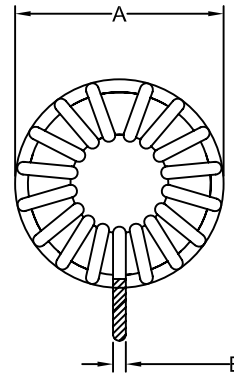

FRONT VIEW

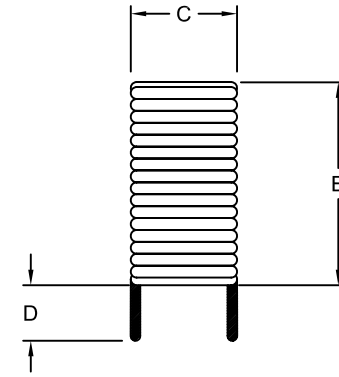

SIDE VIEW

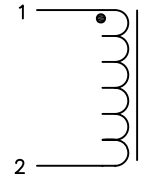

SCHEMATIC

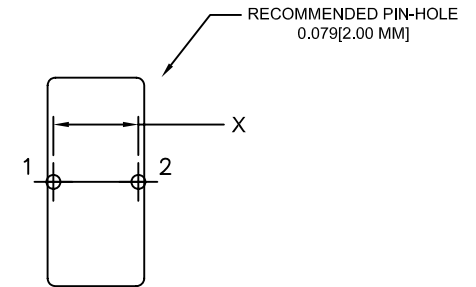

MOUNTING HOLE PATTERN (TOP VIEW)

- 7 BUILT TO RoHS COMPLIANCE AND LEAD FREE.
- 6 IF APPLICABLE, MARK PART NUMBER AND REVISION
- 5 POSITION LEADS AS REQUIRED REMOVE WIRE INSULATION AND TIN
- 4 WIND COILS EVENLY SPACED CONSTRUCTION:
 WEIGHT: ~ 68 GRAMS
 HI-POT WINDING-TO-CORE 1500 V AC, 10 SEC
 INTERWINDING CAPACITANCE 65 pF TYPICAL @ 1 kHz
 DCR = 65 mΩ MAX
 SRF ~ 910 kHz TYPICAL
 MAX TEMP. RISE @ IDC 7 AMP, LESS THAN 40°C WITH NO AIRFLOW
 INDUCTANCE @ 0 AMP = 470 uH ± 15% (LESS THAN 10% RIPPLE)
 TEST FREQUENCY: 1 kHz ; TEST VOLTAGE: 250 mV
 RATED MAX. CURRENT = 7 AMPS RMS ; FREQUENCY: 1 kHz
 OPERATING TEMPERATURE RANGE : -40° TO 85°C
 SPECIFICATIONS @ 25°C
- 3 WIRE: UL RATED CLASS 155°C
 CORE: POWDERED CORE
- 2 RATING UL-CLASS B (130°) REQUIRED
 MATERIAL: UL RECOGNIZED 94V-0 FLAMMABILITY
- 1

NOTES: UNLESS OTHERWISE SPECIFIED. READ FROM BOTTOM UP.

CODE IDENT	MFG. P/N	DESCRIPTION	ITEM NO.
PARTS LIST			
AUTOCAD	X	WWW.COILWS.COM, INC sales@coilws.com	CWS Coil Winding Specialist. 353 W Grove Ave Orange, CA 92865 (CAGE 3C994)
SOLIDWORKS			
SIGN	DATE	TITLE: POWER INDUCTOR, VERTICAL 470 uH, 7 Amp	
DRAWN	RPR 01/25/05		
CHECKED	JLAU 01/25/05		
ENGR.	KSUM 01/25/05		
APPR.	JLAU 01/25/05	SIZE B DWG. NO. TC-471M-7A-130V	REV C
DO NOT SCALE DRAWING		SCALE 2=1	SHEET 1 OF 1

DC Bias Comparison (1 kHz)

