

The information contained in this drawing is the sole property of CWS Coil Winding Specialist. Any reproduction in part or whole without written permission of CWS Coil Winding Specialist is prohibited.

REVISION HISTORY			
REV	ECN	DESCRIPTION	DATE
C		PRODUCTION RELEASE	12/07/04

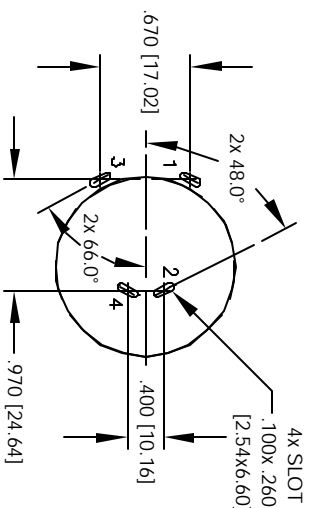
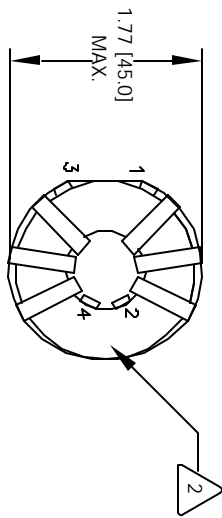
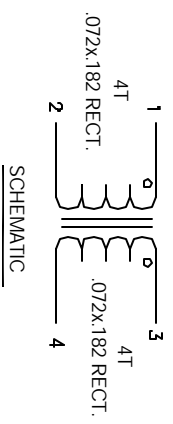
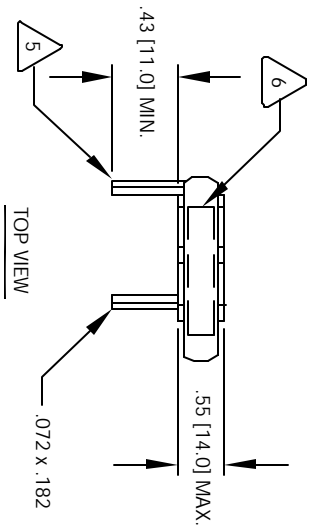

6 USING A PERMANENT MARKING METHOD MARK PART NUMBER AND REVISION WRAP INDUCTOR WITH TAPE. (PER NOTE 2)

5 TO THE CORE MUST REST FLAT ON PCB. LEADS MUST BE TANGENT FLUSH WITH THE COIL EDGE, AS SHOWN (I.E. COIL REMOVE INSULATION AND TIN LEADS APPROX. 0.40 INCH

4 CORE AND EVENLY SPACED, POLARITY NOTED WIND 4 TURNS, .072x .182 RECT. SINGLE LAYER ON EACH SIDE OF CONSTRUCTION:

3 TO INSURE INTEGRITY OF WINDING SEPARATION HI-POT TEST FOR INTERWINDING ISOLATION = 250VDC POWERLOSS = 5.2 W MAX. @ 80A/COIL DCR = 4 MOHMS MAX./COIL L = 52 uH MIN / COIL, 70 uH NOM / COIL, 1 KHZ, 1Vrms SPECIFICATIONS @ 25 °C:

2 APPROVED PART OUTER WRAP: 3M #11 OR #69 OR OTHER CWS WIRE: UL RECOGNIZED 200°C RATING MAGNET WIRE CWS BYTEMARK OR OTHER APPROVED PART CORE: COATED FERRITE TOROID, HIGH PERM MNZN

1 CLASS B (130°C) REQUIRED MATERIAL: UL RECOGNIZED 94V-0 FOR FLAMMABILITY NOTES: UNLESS OTHERWISE SPECIFIED.

QTY	CODE IDENT	MFG. P/N	DESCRIPTION	ITEM NO.
			PARTS LIST	
			COILS.COM, INC	
			1510 E. Edinger Ave.	
			Unit B, Santa Ana, CA 92705	
			Inductor Common Mode	
			70uH 80A	
			C-36A29-06	
			SCALE 1=1	
			SHEET 1 OF 1	