

The information contained in this drawing is the sole property of CWS Coil Winding Specialist. Any reproduction in part or whole without written permission of CWS Coil Winding Specialist is prohibited.

REVISION HISTORY

REV	ECN	DESCRIPTION	DATE	BY	DATE
A		PRODUCTION RELEASE	5/16/04	JLU	5/16/04

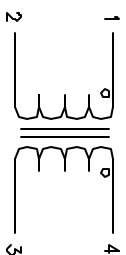
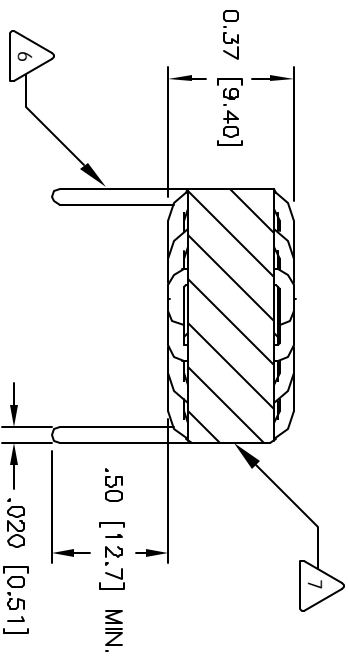

- 7 WHERE SHOWN, USING A PERMANENT MARKING METHOD MARK PART NUMBER AND REVISION WRAP INDUCTOR WITH GLASS TAPE
- TO THE CORE MUST REST FLAT ON PCB. LEADS MUST BE TANGENT FLUSH WITH THE CORE EDGE, AS SHOWN (I.E. COIL REMOVE INSULATION AND TIN LEADS APPROX. 0.5 INCH
- 5 SPACER : UL 94-V0, NYLON 6/6
- 4 WIND BOTH COILS EVENLY SPACED CONSTRUCTION:
- INTER-WINDING CAPACITANCE = 20.20 pF
LEAKAGE INDUCTANCE = 27.3 uH
CURRENT RATING = 2.3 AMPS
DCR ON EACH WINDING = 75.0 MILLI-OHMS MAX
L = 4900 uH ± 30%, 10 KHZ, 250 mV
- 3 SPECIFICATIONS:
- WIRE: UL RECOGNIZED 155 °C OR 200 °C (PREFERRED) RATED MAGNET WIRE
CWS BYTE-MARK OR OTHER APPROVED PART
CORE: COATED FERRITE TOROID, HIGH PERM MNZN
- 2 RATING CLASS B (130 °C MIN.) REQUIRED MATERIAL: UL RECOGNIZED 94V-0 FOR FLAMMABILITY

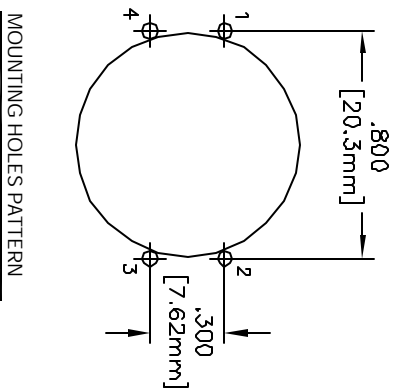
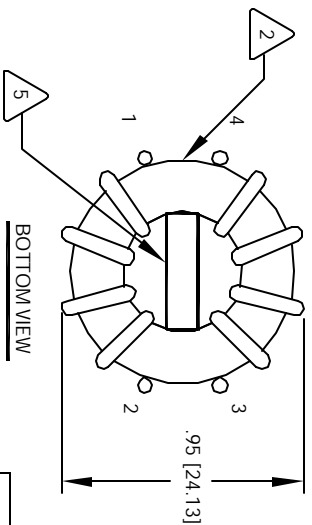

NOTES: UNLESS OTHERWISE SPECIFIED, COMMON MODE CHOKE

CODE IDENT	MFG. P/N	DESCRIPTION	ITEM NO.
AUTOCAD SOLIDWORKS SIGN	X		
DATE	DATE		
5/17/04	5/16/04		
DATE	DATE		
5/16/04	5/16/04		
DATE	DATE		
5/16/04	5/16/04		
DATE	DATE		
5/16/04	5/16/04		
DATE	DATE		
5/16/04	5/16/04		