

The information contained in this drawing is the sole property of CWS Coil Winding Specialist. Any reproduction in part or whole without written permission of CWS Coil Winding Specialist is prohibited.

REVISION HISTORY

REV	ECN	DESCRIPTION	DATE	BY	CHK	DATE
0		PRODUCTION RELEASE	9/08/04	JLU		9/08/04

FRONT VIEW

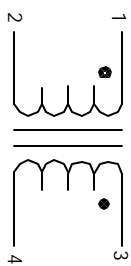
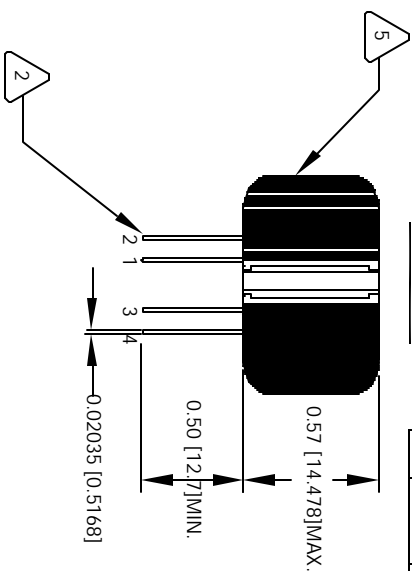

SCHEMATIC

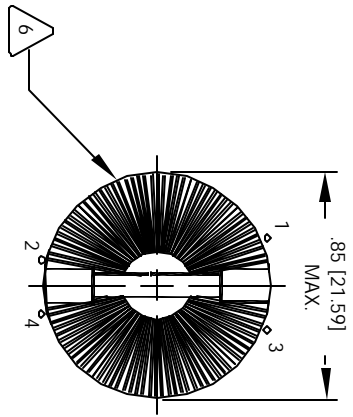

BOTTOM VIEW

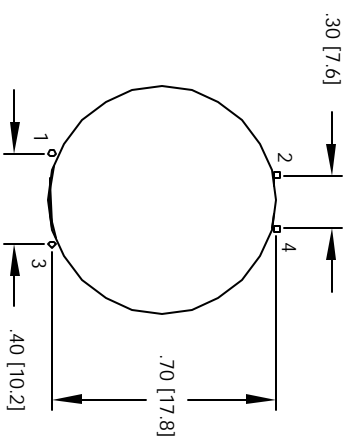

MOUNTING HOLES PATTERN



BOBBIN RATING CLASS B (130°C) REQUIRED
MATERIAL: UL RECOGNIZED 94V-0 FOR FLAMMABILITY
CORE: FERRITE TOROID.



WIRE: UL RECOGNIZED 130°C RATED MAGNET WIRE
CWS BYTE-MARK OR OTHER APPROVED PART

1 MATERIAL: UL RECOGNIZED 94V-0 FOR FLAMMABILITY

2 CORE: FERRITE TOROID.

3 SPECIFICATIONS AT 25 °C

4 RATED CURRENT = 2.0 AMPS

5 TEST FREQUENCY = 10 KHZ

6 TEST RANGE = -25 °C TO 120 °C
MAX TEMP RISE = 28.4 °C
TEST VOLTAGE = 2000 VAC, 1 MIN
RATED VOLTAGE = 250 VAC OR VDC
TOTAL DCR OF BOTH WINDINGS = 0.1317 OHMS MAX COMBINED
L = 1.0 mH NOMINAL, 50 Hz - 400 KHz, 0.250 Vrms, 0 ADC
INSULATION RESISTANCE = 100 MEGA-OHMS MIN. @ 500 VDC

UNLESS OTHERWISE SPECIFIED
DRAWING AND TOLERANCE PER ANSI Y14.5M
ALL DIMENSIONS ARE IN INCHES AND (DIMETERS)
TOLERANCE INCHES: ±.0005
TOLERANCE METERS: ±.0025
ANGLE PROJECTION
DO NOT SCALE DRAWING

QTY	CODE	MFG. P/N	DESCRIPTION	ITEM NO.
	IDENT			
	X			
PARTS LIST				
AUTOCAD SOLIDWORKS SIGN		CWS Coil Winding Specialist 1510 E. Edinger Ave. Unit B, Santa Ana, CA 92705		
DATE		DATE		
9/09/04	9/09/04			
TITLE: Common Mode Chokes				
DRWN: RFR	CHK: JLU	SIZE: DIM. IN.	LFH-102U-1A	REV: D
ENGR: KSIUM	APPR: JLU	SCALE: 2=1		
9/09/04	9/09/04			