

The information contained in this drawing is the sole property of CWS Coil Winding Specialist. Any reproduction in part or whole without written permission of CWS Coil Winding Specialist is prohibited.

REVISION HISTORY			
REV	ECN	DESCRIPTION	SIGN & DATE
A		PRODUCTION RELEASE	RRR 5/18/04 JLU 5/13/04

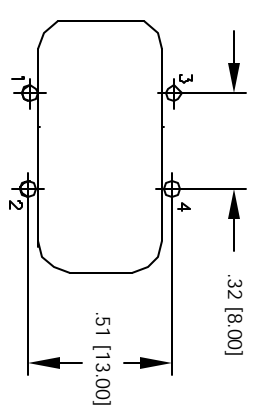
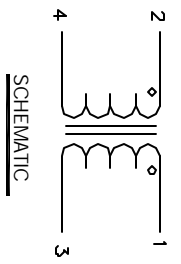
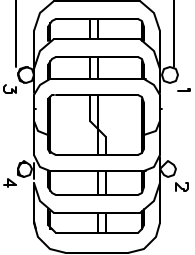
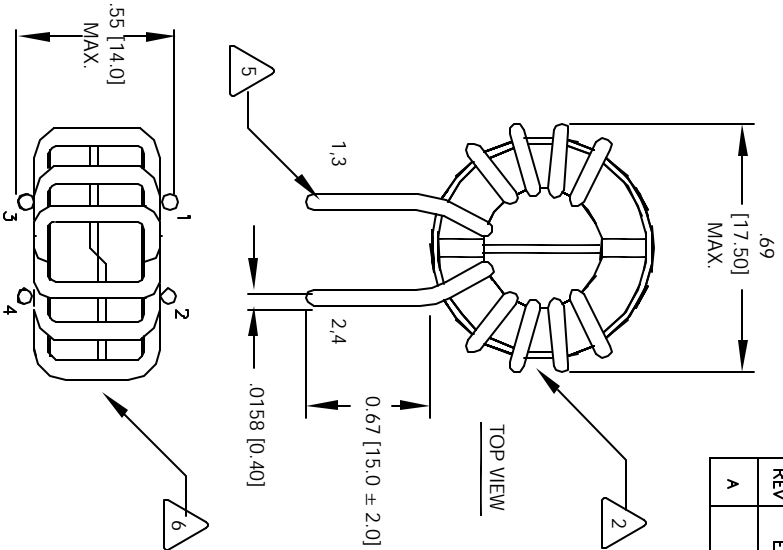

- 6 WHERE SHOWN  
IF APPLICABLE, MARK PART NUMBER
- 5 FLUSH WITH THE COIL EDGE, AS SHOWN  
REMOVE INSULATION AND TIN LEADS
- 4 WIND ON EACH SIDE TO CORE AND EVENLY SPACED  
CONSTRUCTION:  
TEMP RANGE = -25 °C TO 105 °C  
MAX TEMP RISE = 40 °C  
TEST VOLTAGE = 2000 VAC, 1 MIN.  
DCR = 120 MILLI-OHMS EACH LINE, MAX.  
RATED VOLTAGE = 250 V AC OR DC  
RATED CURRENT = 1 AMPS  
L = 3.0 mH MIN., 10 KHZ, 0.250 Vrms, 0 ADC  
INSULATION RESISTANCE = 100 MEGA-OHMS MIN. @ 500 VDC  
SPECIFICATIONS AT 25 °C:
- 3

- 2 WIRE: UL RECOGNIZED 130 °C RATED MAGNET WIRE  
CWS BYTE-MARK OR OTHER APPROVED PART  
CORE: FERRITE TOROID, HIGH PERM MINZN
- 1 BOBBIN RATING CLASS B (130 °C) REQUIRED  
MATERIAL: UL RECOGNIZED 94V-0 FOR FLAMMABILITY

NOTES: UNLESS OTHERWISE SPECIFIED, COMMON MODE CHOKE.

QTY	CODE IDENT	MFG. P/N	DESCRIPTION	ITEM NO.
			<b>PARTS LIST</b>	
	AUTOCAD SOLIDWORKS SIGN	X		
	DATE			
TITLE: <b>Small Common Mode Chokes</b> <b>Vertical Mount S Series</b>				
DRAWN: RFR 5/15/04				
CHKD: JLU 5/15/04				
ENGR: KSUM 5/15/04				
APPR: JLU 5/15/04				
SIZE: DIM. IN. <b>B</b>				
SCALE: <b>2=1</b>				
SHEET 1 OF 1				