

The information contained in this drawing is the sole property of CWS Coil Winding Specialist. Any reproduction in part or whole without written permission of CWS Coil Winding Specialist is prohibited.

REVISION HISTORY

REV	ECN	DESCRIPTION	DATE	BY	CHK	DATE
A		PRODUCTION RELEASE	5/15/04	RRR	JLU	5/13/04

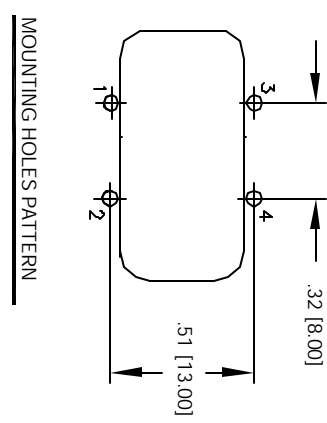
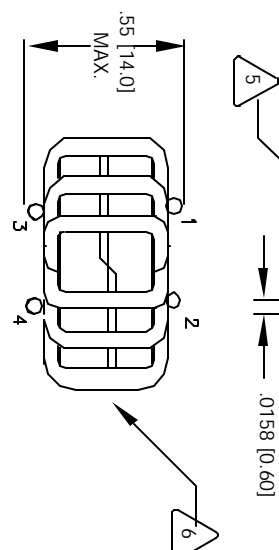
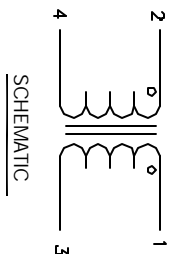
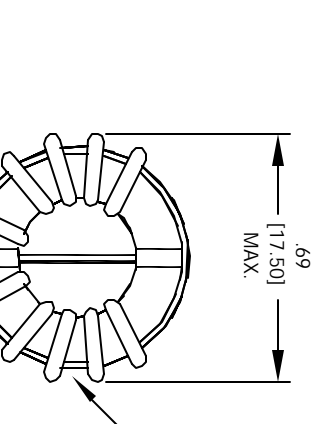

6 WHERE SHOWN
IF APPLICABLE, MARK PART NUMBER

5 FLUSH WITH THE COIL EDGE, AS SHOWN
REMOVE INSULATION AND TIN LEADS

4 WIND ON EACH SIDE TO CORE AND EVENLY SPACED
CONSTRUCTION:

- TEMP RANGE = -25 °C TO 105 °C
- MAX TEMP RISE = 40 °C
- TEST VOLTAGE = 2000 VAC, 1 MIN.
- DCR = 35 MILLI-OHMS, EACH LINE MAX.
- RATED VOLTAGE = 250 V AC OR DC
- RATED CURRENT = 3 AMPS
- L = 1.0 mH MIN., 10 KHz, 0.250 Vrms, 0 ADC
- INSULATION RESISTANCE = 100 MEGA-OHMS MIN. @ 500 VDC
- SPECIFICATIONS AT 25 °C:

2 WIRE: UL RECOGNIZED 130 °C RATED MAGNET WIRE
CWS BYTE-MARK OR OTHER APPROVED PART
CORE: FERRITE TOROID, HIGH PERM MINZIN

1 BOBBIN RATING CLASS B (130 °C) REQUIRED
MATERIAL: UL RECOGNIZED 94V-0 FOR FLAMMABILITY

NOTES: UNLESS OTHERWISE SPECIFIED, COMMON MODE CHOKE.

UNLESS OTHERWISE SPECIFIED	UNLESS OTHERWISE SPECIFIED
DRAWING AND TOLERANCE PER ANSI Y14.5M	TOLERANCE PER ANSI Y14.5M
ALL DIMENSIONS ARE IN INCHES AND [DIMENSIONS]	ALL DIMENSIONS ARE IN INCHES AND [DIMENSIONS]
TOLERANCE INCHES: .0005-.0015	TOLERANCE METERS: .0025-.0038
ANGLES: 127° .0005-.0038	ANGLES: 127° .0005-.0038
ANGLE PROJECTION	ANGLE PROJECTION
DO NOT SCALE DRAWING	DO NOT SCALE DRAWING

QTY	CODE IDENT	MFG. P/N	DESCRIPTION	ITEM NO.
			PARTS LIST	
			AUTOCAD SOLIDWORKS SIGN	X
			DATE	
			DRAWN	
			CHKD	
			APPD	
			DATE	
			SCALE	
			SIZE	
			REV	